



hydor

hydroponics

With more than 50 years of accrued experience in the agricultural and horticultural industry Hydor is an expert in Hydroponics fans and associated ventilation equipment.

Irrespective of whether Hydroponic crops are grown on a size and scale for either commercial or residential consumption, Hydor are committed to providing growers with the right air movement conditions through suitable fans and controllers to optimise climate control.

contents

- 4 Introduction
- 6 What We Do
- 7 Air Movement
- 8 Fan Selection
- 10 Product Selector
- 12 HIT Centrifugal Extractor Fan
- 14 HIMF Mixed Flow Fan
- 15
- 16
- 17 HVFB Typhoon Fan
- 18 HPFA Pedestal Fan
- 19 HWFA Wall Fan
- 20 HTS Turbulator Recirculation Fan
- 22 HV Belt Drive Fan

introduction

Environmental control for Hydroponics.

Hydroponics is playing an increasingly important role in horticultural production; providing commercial & domestic growers with a wide variety of fresh produce including fruit, vegetables, cut flowers and other leading crops.

Air movement is an essential part of maintaining optimal growth conditions inside greenhouses, grow rooms or other protected crop structures. High quality airflow assists by modifying temperature, humidity and carbon dioxide levels at the leaf surface where the important plant process of photosynthesis and transpiration are occurring.

Correctly designed and installed systems can also reduce incidences of associated diseases such as mildew and Botrytis as well as bacterial infection.

Hydor product range is designed specifically for Hydroponic growers and stand out from the crowd in many areas including the design and choice of materials, their noise and performance characteristics and their product attributes. Most importantly, are the benefits that come from our constant efforts to unite Hydor's products with our customers expectations.





air movement

Good ventilation that continuously replenishes the air is critical for healthy plant growth.

Providing the correct amount of air movement across a leaf surface is essential for good production and yields, and can signify the difference between high rates of photosynthesis taking place or none at all. High-quality air flow also assists temperature control, carbon dioxide replenishment, lowers humidity and diminishes the incidence of specific diseases.

Even a small amount of air movement over the leaf will remove stale, humid air from the boundary layer that lies just above and just below the leaf surface. This boundary layer of air supplies the leaf with carbon dioxide and also holds much of the moisture transpired by the plant.

If there isn't any air movement, diffusion of water vapour out of the leaf and carbon dioxide into the leaf begins to slow, as the mixing of the boundary layer air into the rest of the environment is too slow.

One of the most effective methods for cooling greenhouses, grow rooms and other protected cropping structures is having adequate air flow supplied in from the outside and then extracted out again. The amount of ventilation necessary to sustain the ideal temperature range, will depend on factors such as the temperature of the incoming air and the heat load from lights in the growing area, as well as the quantity of air drawn in and removed again on a regular basis.



High humidity levels can become a major problem where plants with large leaf areas, in a warm but restricted growing environment, are continually transpiring and releasing water vapour into the air.

Ideal humidity levels for most plants are in the range of 70 - 80%, however the higher the humidity level, the greater the risk of certain plant diseases such as mildew and Botrytis as well as bacterial infection where moisture forms on the leaf surface.

At Hydor, our range of fans for growing applications are designed to not only extract the humid air, but also supply drier air to the growing area; essential for enhanced plant growth and disease prevention.

When humidity levels are high, condensation at night can become a major problem, by providing the perfect environment for many fungal spores and bacterial diseases to infect the plants. Air movement is an effective way to reduce humidity and prevent condensation- protecting the plants from disease outbreak.

Hydor's commitment to providing growers with correctly sized supply/extract fans, well positioned circulating fans and control systems, culminates in the very best conditions for growth, development and maximum yields.

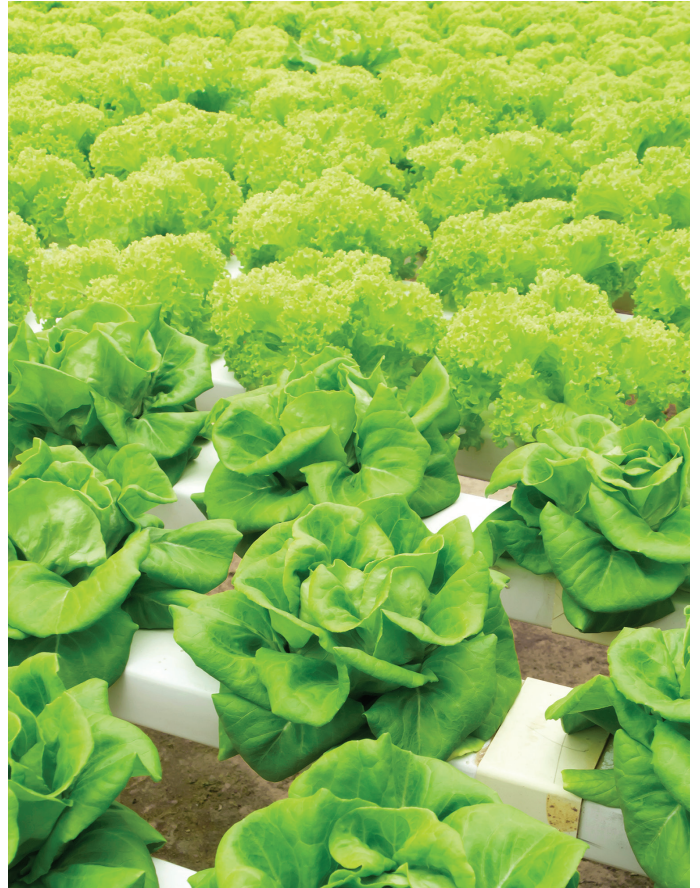

fan selection

Fan Selection for greenhouses, grow rooms and other protected crop structures

Ventilation system

Selecting the correct fan for a growing area is important for plant growth and development as well as disease prevention. The most effective set up comprises of a low level intake with the extract fan(s) positioned at a higher level on the opposite side of the room. The cool, drier air sucked in from outside will flow up, through and over the crop and warmer, moist air which rises, will be extracted by the fan at the other end of the room. Wall or floor mounted circulation fans should be positioned to assist the extract fan and increase the airflow up and under plants, avoiding stale air pockets which may be prone to fungal or bacterial disease attack.

How much airflow?

If excess heat in a certain growing environment is a common problem, or there is a large volume of plants growing in a very restricted space, you will need more air flow per hour than for a larger growing area that doesn't suffer from excessive heat build up. Growers commonly underestimate just how much air exchange is required to remove excess heat or humidity, bring in fresh carbon dioxide and generally create fresh air movement over all of the plant surfaces.

Greenhouse crops in full sunlight with large, mature crops growing in warm, humid conditions will require 60 air changes per hour. During winter months, fans are required to remove warm moisture-laden air to reduce the humidity rather than reducing the temperature. The minimum winter airflow rate for controlling humidity and condensation should never be allowed to drop below 2 air changes per hour.

In smaller grow rooms, 12 to 15 air changes per hour would be acceptable. However, this would need to increase to 20 to 30 air changes per hour if a lot of extra heat due to lighting needed to be removed, or if carbon dioxide enrichment was not being used.

Fan types

Axial fan

Used to move large volumes of air against little resistance.

Centrifugal fan

Used to overcome the resistance caused by long duct runs, insect screens and filters.

Mixed flow fan

A combination of an axial and centrifugal fan suitable for relatively large air volumes and high resistances.

How to select a fan

Step 1:

Calculate the volume of the growing area by multiplying the length x width x height (a nominal 2.4m for greenhouses). This will give the volume of the growing room in m³.

Step 2:

Decide on the number of air changes that are required to ventilate the growing room in warm conditions; this is the maximum airflow rate.

Step 3:

Multiply the volume of the growing room x the number of air changes per hour. This will give the required airflow rate in m³/hour. Fans are normally rated in terms of m³/hour or in m³/second. To convert from m³/hr to m³/s, divide by 3600.

Air Flow Path in Small Grow Room

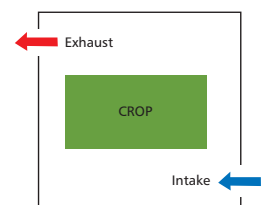

Small Grow Room Example

How to select a fan

Room Volume

$$= L (4) \times W (4) \times H (2.5) \\ = 40\text{m}^3$$

Based on a minimum of 20 air changes per hour

The ventilation rate required

$$= 40 \times 20 \\ = 800 \text{ m}^3/\text{hr} \\ = \frac{800}{3600} \\ = 0.222\text{m}^3/\text{s}$$

∴ Selection : HIT200 or 2 x HIT150

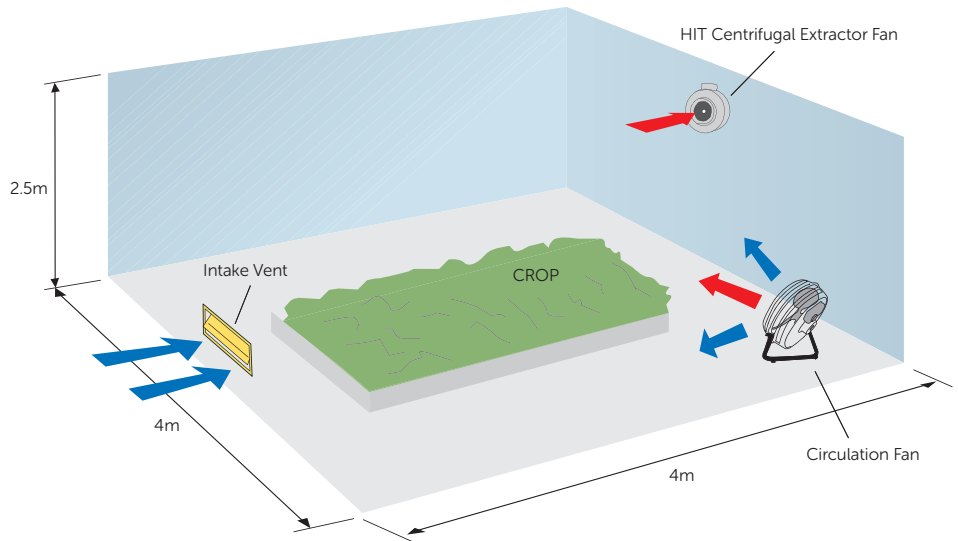

Commercial Hydroponic Greenhouse Example

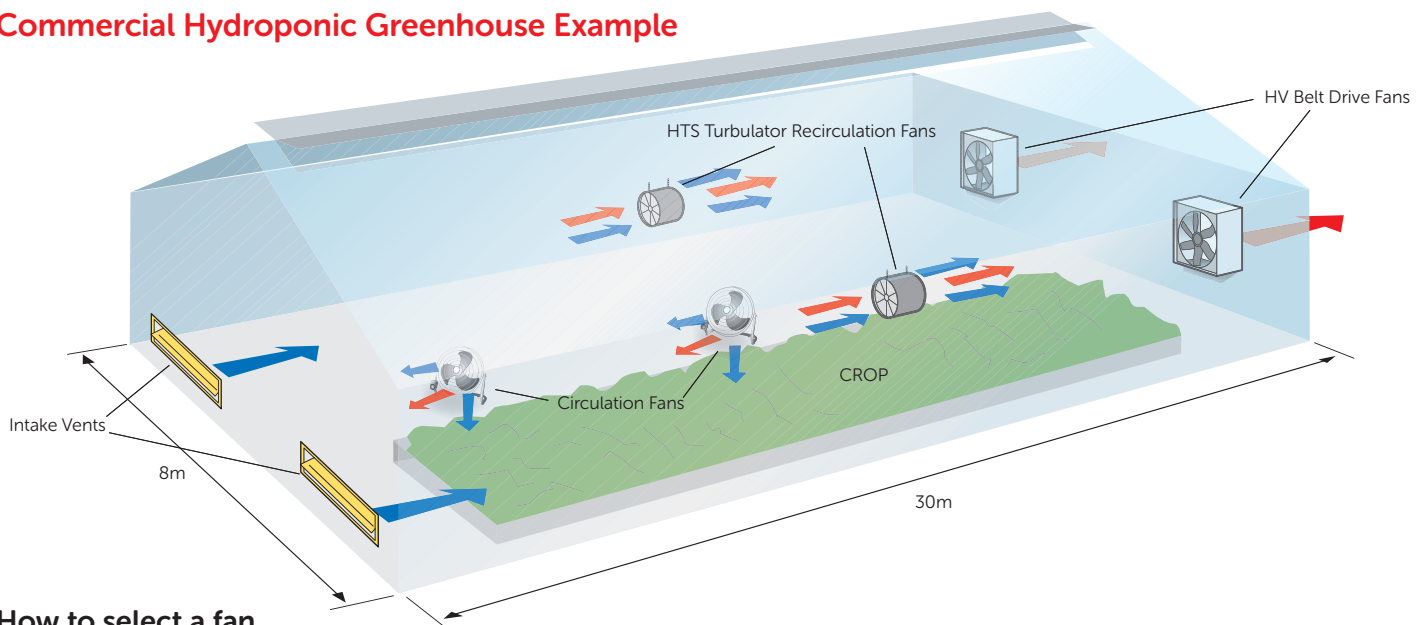

How to select a fan

Greenhouse Volume

$$= L \times W \times H \\ = 30 \times 8 \times 2.4 \\ = 576\text{m}^3$$

Based on a summer ventilation rate of 60 air changes per hour

The ventilation rate required

$$= 576 \times 60 \\ = 34560 \text{ m}^3/\text{hr} \\ = \frac{34560}{3600} \\ = 9.6\text{m}^3/\text{s}$$

∴ Selection : 2 x HV80

The winter ventilation rate of 15 air changes per hour can be achieved by dropping the fan speed through stepped transformer speed controllers.

product selector

The product selector is designed to provide a simple overview of the products we offer for hydroponic applications.

Minimum and maximum weights expressed based on fan diameter size range | HV Weights detailed include louvre



HIT Centrifugal Extractor Fan

pg 12

Product Code **HIT**

Airflow m³/s **0.517**

Impellers **Three speed backward curved centrifugal impeller**

Motors **Weatherproofed to IP44, Class F Insulation**

Ambient Operating Temperature **50°C**

Weight (kg) **3.6 - 8.8**



HIMF Mixed Flow Fan

pg 14

Product Code **HIMF**

Airflow m³/s **0.258**

Impellers **Two speed mixed flow impeller**

Motors **Weatherproofed to IP44, Class F Insulation**

Ambient Operating Temperature **50°C**

Weight (kg) **2.4 - 4**



HVFB Typhoon Fan

pg 17

Product Code **HVFB** | Airflow m³/s **1.83**

Impellers **Fixed pitch aluminium bladed (3 blades)**

Motors **High performance 3 speed**

Ambient Operating Temperature **50°C**

Weight (kg) **2.3 - 5.9**



HPFA Pedestal Fan

pg 18

Product Code **HPFA**

Airflow m³/s **Up to 3.83**

Impellers **High quality aluminium, Epoxy powder coated (2 Blades)**

Motors **High performance motors**

Ambient Operating Temperature **45°C**

Weight (kg) **23**

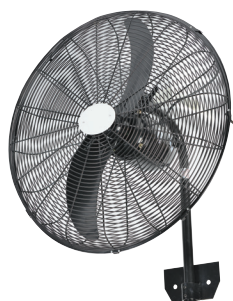

HWFA Wall Fan

pg 19

Product Code **HWFA**

Airflow m³/s **Up to 3.83**

Impellers **High quality aluminium, Epoxy powder coated (2 Blades)**

Motors **High performance motors**

Ambient Operating Temperature **45°C**

Weight (kg) **14.3**

HTS Turbulator Recirculation Fan

pg 20

Product Code **HTS**

Airflow m³/s **1.27 - 2.86**

Impellers **Fixed Pitch, Glass, Reinforced polypropylene (4 blades)**

Motors **Induction motors, Weatherproofed to IP55, Class F Insulation**

Ambient Operating Temperature **50°C**

Weight (kg) **13 - 29**



HV Belt Drive Fan

pg 22

Product Code **HV**

Airflow m³/s **Up to 20.13**

Impellers **Stainless steel impeller blades (6 blades)**

Motors **Totally enclosed metric to IP55, Class F Insulation**

Ambient Operating Temperature **50°C**

Weight (kg) **44 - 100**

conversions

volume

1 m³/hr = 0.00028 m³/s = 0.278 L/s = 0.589 CFM

pressure

1" WG = 249.1 Pa

velocity

1 m/s = 196.85 ft/min

power

1 Hp = 0.746 kW

HIT Centrifugal Extractor Fan

HIT fans are designed specifically for smaller greenhouse and grow room ventilation applications, providing high airflow performance, quiet operation and the flexibility of a powerful three speed motor for high, medium or low airflow settings.



product information	Speed (r/min)	Airflow @ Static Pressure (Pa)										Overall Eff. %	Input (kW)	FLC (Amps)	dBA @ 3m
		0	100	200	250	300	350	400	450	500					
HIT125	High	2690	0.087	0.065	0.046	0.036	0.023					16.2	0.058	0.30	47
	Med	2550	0.078	0.055	0.037	0.028	0.013					16.2	0.058	0.27	44
	Low	2410	0.072	0.047	0.029	0.008						16.2	0.058	0.27	38
HIT150	High	2590	0.130	0.108	0.078	0.060	0.039	0.001				25.2	0.065	0.28	47
	Med	2320	0.112	0.081	0.051	0.036	0.015					25.2	0.065	0.26	44
	Low	2180	0.090	0.049	0.029	0.017						25.2	0.065	0.25	38
HIT160	High	2500	0.129	0.104	0.075	0.058	0.034	0.006				25.0	0.064	0.28	47
	Med	2170	0.110	0.081	0.047	0.028	0.009					25.0	0.064	0.24	44
	Low	2030	0.098	0.062	0.031	0.016	0.005					25.0	0.064	0.23	38
HIT200	High	2520	0.254	0.225	0.187	0.165	0.139	0.109	0.075	0.038		28.1	0.158	0.71	51
	Med	2315	0.220	0.165	0.109	0.089	0.071	0.054				28.1	0.158	0.61	47
	Low	1420	0.189	0.073	0.059							28.1	0.158	0.59	42
HIT250	High	2610	0.254	0.218	0.176	0.150	0.120	0.080	0.006			29.2	0.132	0.57	52
	Med	2405	0.244	0.201	0.145	0.112	0.076	0.036				29.2	0.132	0.51	49
	Low	2230	0.231	0.186	0.113	0.083	0.054	0.016				29.2	0.132	0.50	44
HIT250B	High	2390	0.311	0.268	0.208	0.173	0.141	0.115	0.090	0.066	0.040	25.2	0.167	0.79	52
	Med	2300	0.241	0.144	0.093	0.078	0.066	0.054	0.043	0.030		25.2	0.167	0.66	47
	Low	2090	0.190	0.077	0.051	0.043	0.035	0.028	0.021			25.2	0.167	0.59	41
HIT315	High	2235	0.354	0.310	0.236	0.199	0.116	0.134	0.102	0.069	0.037	22.2	0.191	0.85	56
	Med	2120	0.334	0.271	0.153	0.121	0.096	0.074	0.055	0.036	0.98	22.2	0.191	0.82	51
	Low	1880	0.320	0.226	0.120	0.094	0.072	0.051	0.031	0.010		22.2	0.191	0.80	46
HIT315B	High	2230	0.517	0.457	0.369	0.313	0.261	0.219	0.183	0.152	0.124	29.5	0.275	1.19	56
	Med	2250	0.485	0.399	0.267	0.222	0.187	0.157	0.130			29.5	0.275	1.10	54
	Low	2140	0.449	0.344	0.200	0.167	0.140	0.115	0.090			29.5	0.275	1.04	52

Data in accordance with ErP 1253/2014 of the European Parliament. Product category is NRVU. Measurement category used to determine energy efficiency: D. For EASI models add SP to the product code. The overall A-weighted sound pressure level is at a distance of 3m with spherical free-field propagation. It is expressed in dB re-20μPa and is presented for comparative purposes only.

IP55
protection

50°C
temperature

dimensional drawing

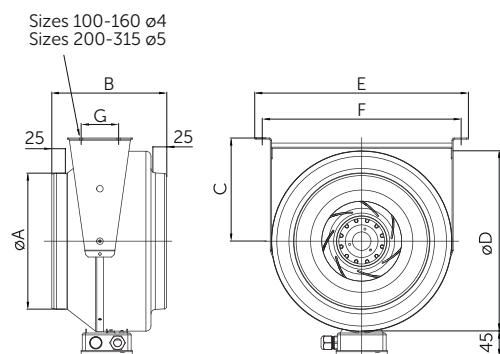

Dimensions in mm.

features and benefits

- Designed for easy, direct connection to standard diameter flexible ducting with 25mm long spigots
- Heavy gauge pressed steel housing, which is durable, long lasting, UV and ozone resistant
- Integral guide vanes reduce turbulence for a smoother airflow
- Three speed backward curved centrifugal impeller allows the desired speed setting to be selected either at the time of installation, or by an optional remote mounted three speed switch for high, medium and low settings
- Integral thermal overload protection which prevents the motor from overheating. Motors have sealed for life bearings
- IP54 rated terminal box which is fitted onto the outside of the unit casing
- A high efficiency, single inlet, single width, backward curved centrifugal impeller design which is non-overloading and self cleaning

dimensions

	A	B	C	D	E	F	G	Weight (kg)
HIT100	98	204	130	236	284	270	47	3.7
HIT125	123	204	130	236	284	270	47	3.7
HIT150	148	193	130	236	326	312	47	3.6
HIT160	158	195	165	278	326	312	47	3.6
HIT200	198	195	165	278	392	372	100	5.5
HIT250	248	210	190	333	392	372	100	5.3
HIT315	313	265	227	400	460	440	100	8.8

Dimensions in mm.

accessories

	Flexible Duct	Fast Clamps	Backdraught Dampers	Single Phase Electronic Controller	Single Phase 3 Speed Controller	Single Phase Transformer Voltage Controller
HIT100	HFD100X3	HFCLP100	HBS100	HFC1.7	HFT1.7	TC012
HIT125	HFD125X3	HFCLP125	HBS125	HFC1.7	HFT1.7	TC012
HIT150	HFD150X3	HFCLP150	HBS150	HFC1.7	HFT1.7	TC012
HIT160				HFC1.7	HFT1.7	TC012
HIT200	HFD200X3	HFCLP200	HBS200	HFC1.7	HFT1.7	TC012
HIT250(B)		HFCLP250	HBS250	HFC1.7	HFT1.7	TC012
HIT315(B)		HFCLP315	HBS315	HFC1.7	HFT1.7	TC012

HIMF Mixed Flow Fan

IP44
protection

50°C
temperature

A number of growers on a budget like to take advantage of smaller, more restricted spaces. Our HIMF fans are ideally suited for these grow room requirements, yet still powerful enough to extract up to 929 m³/hr of air with low noise levels.



product information	Outlet Diameter	Airflow (L/s) max		Static Pressure (Pa) max		Power (W)		dBA @3m	
		High	Low	High	Low	High	Low	High	Low
HIMF100	100mm	65.6	57.4	176	164	32	33	45	44
HIMF125	125mm	95.7	82.6	157	143	34	33	44	43
HIMF150	150mm	163.2	124.4	176	227	69	58	55	50
HIMF200	200mm	258.9	222.3	236	223	120	106	53	51

Data in accordance with ErP 327/2011 of the European Parliament. Measurement category used to determine energy efficiency: D. The overall A-weighted sound pressure level is at a distance of 3m with spherical free-field propagation. It is expressed in dB re-20μPa and is presented for comparative purposes only.

dimensional drawing

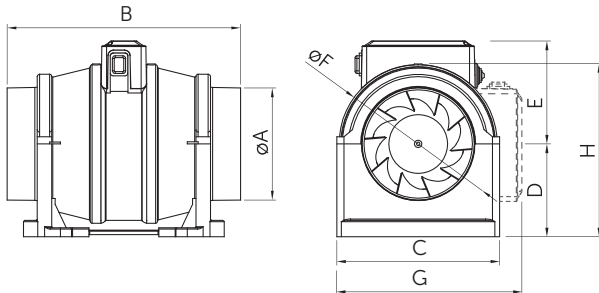

HIMF with easi cable

Ready to run EASI models, supplied with 1.5 metres of flexible cable, two speed high / low & off switch, and fitted with a 13 Amp 3 pin plug.

dimensions	A	B	C	D	E	F	G	H	Weight (kg)
HIMF100	97	296	179	104	113	174	154	139.6	2.4
HIMF125	124	256	179	102	113	174	154	139.6	2.4
HIMF150	147	300	195	112	127	188	182	170	3.0
HIMF200	198	310	254	129	146	228	272	243	4.0

accessories	Fixed Grille	External Gravity Shutters	Internal Extract Valve	Internal Supply Valve	3m Flexible Aluminum Duct
HIMF100	HEG100	HES100	HEV100	HSV100	HFD100X3
HIMF125	HEG125	HES125	HEV125	HSV125	HFD125X3
HIMF150	HEG150	HES150	HEV150	HSV150	HFD150X3
HIMF200	-	-	HEV200	HSV200	HFD200X3

HVFB Typhoon Fan

Floor
mounted

40°C
operation

The Hydor HVFB Typhoon range are versatile circulation fans, ideal in glasshouses for cooling personnel, with a high performance motor, efficient cooling and quiet operation.

features and benefits

- Floor or wall mounted circulation fan
- Ideal for a variety of horticultural, agricultural and equine buildings
- High performance 3 speed motors
- Efficient quiet operation
- Chrome safety guard
- Single phase 220V to 240V 50Hz



product information

	Airflow m ³ /s	Power Watts	Full Load Current A	Maximum Tilt °
HVFB30	0.75	55	0.22	30
HVFB45	1.83	180	0.81	30

dimensional drawing

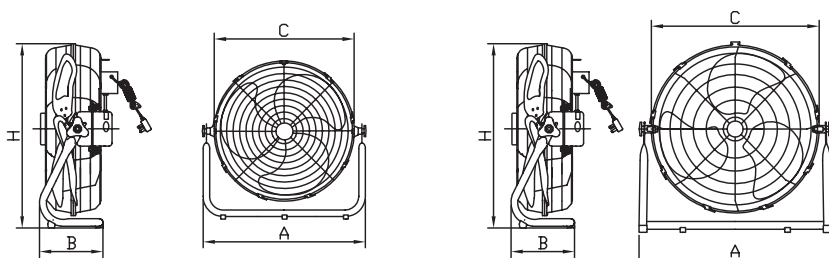

HVFB-30

HVFB-45

dimensions

	Blade Size	A	B	C	H	Weight kg
HVFB30	300	401	182	360	385	3.8
HVFB45	450	555	195	509	525	5.5

Dimensions in mm.

HPFA Pedestal Fan

90°
turning arc

45°C
temperature

The Hydor HPFA Pedestal air circulation fans are designed for use in a wide variety of applications.

Pedestal fans provide the benefit of local cooling for personnel with powerful and effective positive air movement, thereby improving the environmental conditions for both humans and plants.

Pedestal fans can also be positioned in areas subject to stagnant air pockets, where fungal disease can be found, to help rectify these problems.

features and benefits

- Free standing air circulation fan
- Ideal for agricultural, horticultural and commercial applications
- Adjustable height and airflow direction
- 3 speed settings
- Black meshed guard for protection
- Single phase 220V to 240V 50Hz



product information	Speed (r/min)	Airflow (m³/s)	Power (W)	FLC (Amps)	dBA @ 3m	Maximum Tilt	Weight (kg)
HPFA650 Low	890	1.83	130	0.56	46	30°	23
HPFA650 Med	1050	2.83	140	0.62	50	30°	23
HPFA650 High	1380	3.83	170	0.80	59	30°	23

dimensional drawing

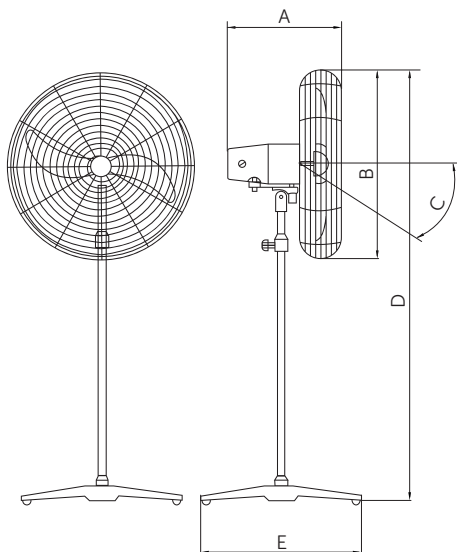

dimensions

	A	B	C	D	E
HPFA	360	690	30°	1460-1860 (min-max)	525

Dimensions in mm

HWFA Wall Fan

90°
turning arc

45°C
temperature

The Hydor HWFA Wall mounted air circulation fans are designed to provide positive air movement and localised cooling whilst maximising space saving.

Carefully positioned and angled wall fans provide supplementary air movement to improve the environmental conditions for both personnel and plants.

features and benefits

- Wall mounted air circulation fan
- Ideal for agricultural, horticultural and commercial applications
- Adjustable airflow direction
- 3 speed settings
- Black meshed guard for protection
- Single phase 220V to 240V 50Hz

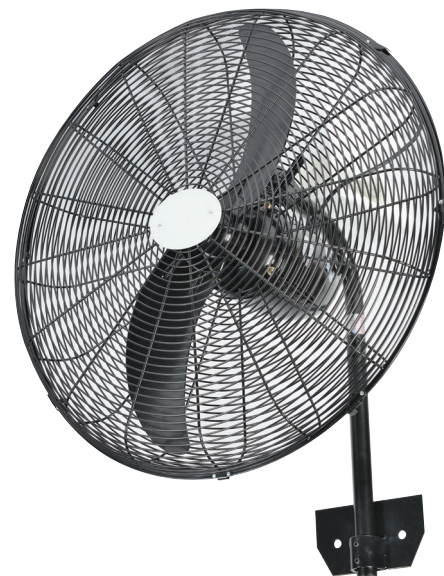

product information	Speed (r/min)	Airflow (m ³ /s)	Power (W)	FLC (Amps)	dBA @ 3m	Maximum Tilt	Weight (kg)
HWFA650 Low	890	1.83	130	0.56	46	30°	14.3
HWFA650 Med	1050	2.83	140	0.62	50	30°	14.3
HWFA650 High	1380	3.83	170	0.80	59	30°	14.3

dimensional drawing

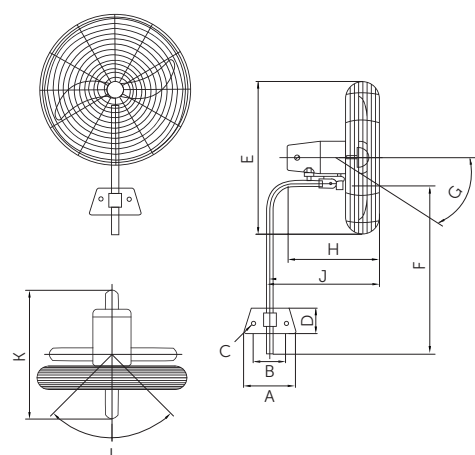

dimensions

	A	B	C	D	E	F	G	H	J	K	L
HWFA	190	114	12.5	112	690	445	30°	360	525	590	90°

Dimensions in mm

HTS Turbulator Recirculation Fan

The Turbulator range of recirculation fans provide a constant airflow and are suitable for all year round ventilation, removing condensation and providing evenness of temperature and humidity throughout a wide variety of agricultural and horticultural buildings.

Designed to circulate air using minimal power consumption, thereby offering a swift payback period.

The range also includes a stainless steel model for more corrosive environments.

Hydor's capabilities in manufacturing and design extend well beyond this, enabling us to provide any additional sizes or bespoke requirements you may have, such as Turbulators with integrated heaters and controls.



key features

- Control of insects in the summer months – many insects and flies are discouraged by the constant airflow created by the circulating fans
- Provides a reduction in livestock heat stress, thereby reducing veterinary expenses
- Air circulation results in improved root growth and a healthier plant in horticulture applications
- Improved evaporation of moisture in the air eliminates condensation on walls and ceilings in winter
- Air circulation moves fumes away from animals, circulating gases to a higher level for extraction at roof level
- Ceiling mounted, provides optimum coverage at any angle
- Disperses dust
- Offers precise environmental control and an improved environment for workers
- Built to withstand challenging, humid and corrosive conditions

IP55
protection

50°C
temperature

product information	Diameter (mm)	Speed (r/min)	Airflow (m ³ /s)	Throw (metres)	dBA @ 3m	Power (kW)	FLC (Amps)
HTS450	450	1360	1.31	23.4	64	0.545	2.31
HTS500	500	945	1.21	19.7	57	0.280	1.33
HTS630	630	945	2.34	22.5	64	0.721	3.15

Alu-Zinc casing as standard. Stainless steel upon request.

Throw termination @0.5m/s.

The overall A-weighted sound pressure level is at a distance of 3m with spherical free-field propagation. It is expressed in dB re-20μPa and is presented for comparative purposes only.

dimensional drawing

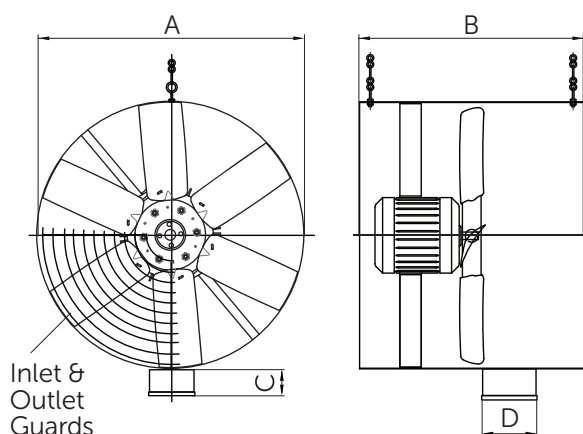

features and benefits

- 3 sizes from 450mm to 630mm diameter
- Suitable for 230V single phase supply
- Rust resistant air straightener for long axial air throw
- Full range of thermostats and speed controllers available
- Lightweight motors
- Non-corrosive plastic impellers for a long service life
- Rust resistant powder coated wire guards
- IP55 rated Junction Box and 3 metre cable with 3 pin plug
- Electronic or manual thermostats available
- Alu-Zinc or stainless steel casings
- Suspension eyes and chain for ease of mounting
- 12 months product warranty

dimensions

	A	B	C	D	Weight (kg)
HTS450	460	440	75	115	20
HTS500	510	440	70	115	19
HTS630	660	630	70	115	30

Dimensions in mm.

accessories

	Inverter Controller	Mechanical Thermostat HS1	Electronic Thermostat HP11W
HTS450	007828	003306	002371
HTS500	007827	003306	002371
HTS630	007828	003306	002371

HV Belt Drive Fan

The Hydor HV Belt Drive fan unit is specifically designed to ventilate larger buildings where substantial amounts of air are moved at low pressure with minimal energy consumption.

The HV range is available in six versions and five sizes; 800mm, 1000mm, 1250mm 1.1kW, 1250mm 1.5kW, 1500mm and 2000mm diameter, each with single or three phase motors and the option of louvres and guards. This powerful fan produces air volumes up to 20m³/s. Constructed from galvanised steel with a specially designed stainless steel impeller, these fans are extremely hard wearing and robust in application. The drive mechanism includes sealed for life maintenance free ball bearings, which means low noise and vibration levels. The HV range is available in three variations; wall mounting with shutters, suspension mounting from the roof space or floor mounting with wheels. The HV range are supplied fully assembled with internal and external safety guards or a centrifugal operated backdraught shutter on the external side.



SINGLE Phase

220V to 240V / 50Hz

	Speed (r/min)	Airflow m ³ /s @ Static Pressure (Pa)						Power (kW)	FLC (Amps)	Start (Amps)	dBA @ 3m
		0	20	40	60	80	100				
HV800	630	4.588	4.091	3.589	2.840	-	-	0.75	4.5	14.3	58
HV1000	520	7.096	6.447	5.550	4.296	3.139	1.827	0.75	5.4	14.9	59
HV1250 (1.1kW)	400	11.002	9.578	8.030	6.190	4.028	-	1.1	7.2	25.7	60
HV1250 H (1.5kW)	440	12.104	10.863	9.465	7.866	5.746	3.189	1.5	8.4	29.5	63
HV1500	360	12.828	11.360	9.503	6.815	-	-	1.5	9.4	33.0	61
HV2000	280	20.137	16.539	12.970	7.639	-	-	1.5	10.0	35.0	59

Measurement category used to determine energy efficiency: A. FLC Amps @ 230V / 1Ph / 50Hz.

THREE Phase

400V / 50Hz

	Speed (r/min)	Airflow m ³ /s @ Static Pressure (Pa)						Power (kW)	FLC (Amps)	Start (Amps)	dBA @ 3m
		0	20	40	60	80	100				
HV800	630	4.588	4.091	3.589	2.840	-	-	0.75	2.0	5.9	58
HV1000	520	7.096	6.447	5.550	4.296	3.139	1.827	0.75	2.6	7.8	59
HV1250 (1.1kW)	400	11.002	9.578	8.030	6.190	4.028	-	1.1	2.9	8.7	60
HV1250 H (1.1kW)	450	11.356	10.208	8.839	7.139	4.947	2.216	1.1	3.0	6.8	62
HV1500	360	12.828	11.360	9.503	6.815	-	-	1.5	3.6	10.8	61
HV2000	280	20.137	16.539	12.970	7.639	-	-	1.5	3.8	12.5	59

Measurement category used to determine energy efficiency: A. FLC Amps @ 400V / 3Ph / 50Hz.
Note: Motor electrical data is approximate, as it varies from one motor manufacturer to another

IP55
protection50°C
temperature

dimensional drawing

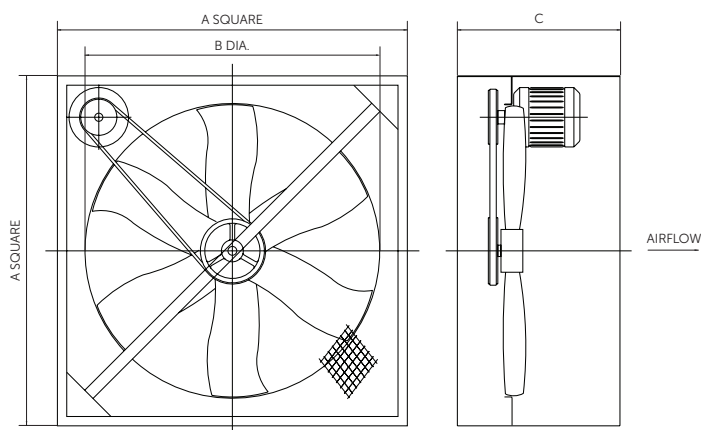

features and benefits

- Free standing air circulation fan
- Ideal for industrial, commercial and agricultural applications
- Extracts stale and humid air from the building
- Fitted with a mesh safety guard on both sides
- 3 step speed switch for increased energy
- Single phase 220V to 240V 50Hz
- Three phase 380V to 440V 50Hz

dimensions

	A	B	C	Depth inc Louvre	Depth inc Louvre & Guard	Weight (kg)	Weight inc Louvre (kg)
HV800	960	800	330	405	470	32	44
HV1000	1150	1000	330	405	470	40	50
HV1250 (1.1kW)	1380	1250	330	405	470	50	70
HV1250 H (1.1kW)	1380	1250	330	405	470	50	70
HV1250 H (1.5kW)	1380	1250	330	405	470	52	72
HV1500	1495	1350	430	430	500	55	85
HV2000	1930	1760	450	450	515	75	100

Dimensions in mm.

accessories

	1Ø 3 Step Speed Controller	1Ø DOL Starter	3Ø DOL Starter	Blackout Filter	HV Wall Cowl	Fixed Intake Weather Louvre with Guard		
						Mill	Paint	Watertight
HV800	FC0149-TC110HV	004828	003644	000295	HVWC800	003316	003320	004625
HV1000	FC0149-TC110HV	004828	004726	000301	HVWC1000	003317	003321	004626
HV1250 (1.1kW)	FC0149-TC110HV	004831	003645	000310	HVWC1250	003318	003322	004627
HV1250 H (1.1kW)	-	-	003645	000310	HVWC1250	003318	003322	004627
HV1250 H (1.5kW)	FC0149-TC112HV	004834	-	000310	HVWC1250	003318	003322	004627
HV1500	FC149-TC116HV	004833	004296	-	HVWC1500	-	-	-
HV2000	-	004833	004296	-	HVWC2000	003319	003323	004628

hydor

t +44 (0) 1725 511422
e info@hydor.co.uk
w www.hydor.co.uk

Hydor Ltd. Unit 8, Parkers Close,
Downton Business Centre, Downton,
Salisbury, Wiltshire SP5 3RB **UK**

ISSUE 4. JUN 2018.

Hydor Ltd has a policy of continuous product development and improvement and therefore reserves the right to supply products which may differ from those illustrated and described in this publication. Confirmation of dimensions and data will be supplied on request.

A MEMBER OF **eg** | **ELTA GROUP**

