

# AQ Air Distribution



## INSULATED DUCTWORK

The key element of this system is the material used to produce the duct and the bend, in twin wall with high thermal and acoustics isolation characteristics.

**Internal structure** realized with insulated foam in a close cells structure to prevent condensation; water repellent to avoid dust deposits.

**External, rigid and corrugated outer casing** in polyethylene resistant to the impacts. Easily cleanable. External ribs which can be easily cut thanks to a saw. The two structures are solidified altogether thanks to the important heat during

the manufacturing process (no glued elements).

**Materials free of toxic additives**, manufactured thanks to a sustainable process in order to reduce as much as possible the wastes and to permit the reutilization of surplus for the next productions.

**Ease of installation and of dismantle** thanks to the mobility of the sheaths and connectors. No adhesive tape required. The connecting parties are slightly flexible to absorb the possible tensions and to prevent the resonance effect.

**Maximum hold** between the parties of the system.

**Noise reduction** as per the Regulation EN-ISO 5135:1999.

**Fixing brackets** required every 2 meters (not supplied).

**Temperature** of application: from  $-40^{\circ}\text{C}$  up until  $+95^{\circ}\text{C}$ .

**100% recyclable.**

## Details



# AQ Air Distribution



## CNDUV

Insulated twin wall ducting – Rigid and corrugated outer casing in polyethylene resistant to the impacts. Inner sheath with insulated foam, water repellent, close cell structure.

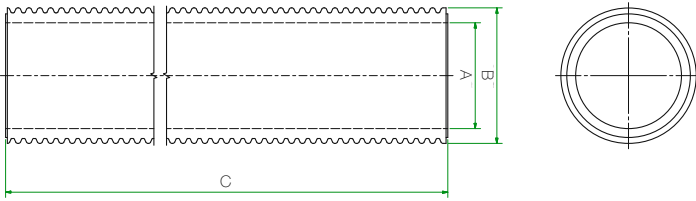

Model	CNDUV 160	CNDUV 200
Code	000078	000071
Ø A	125	170
Ø B	160	200
C	2000	2000

Dimensions in mm

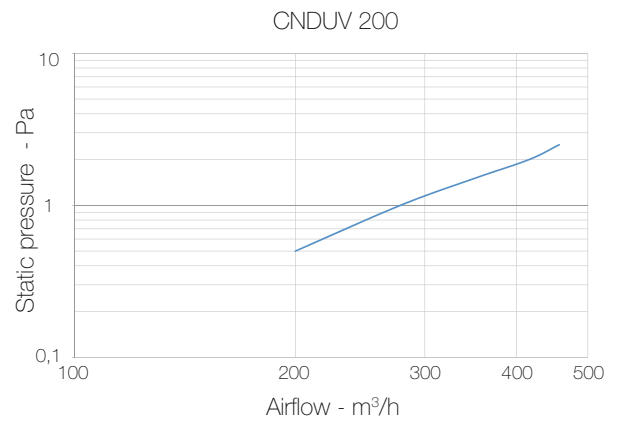
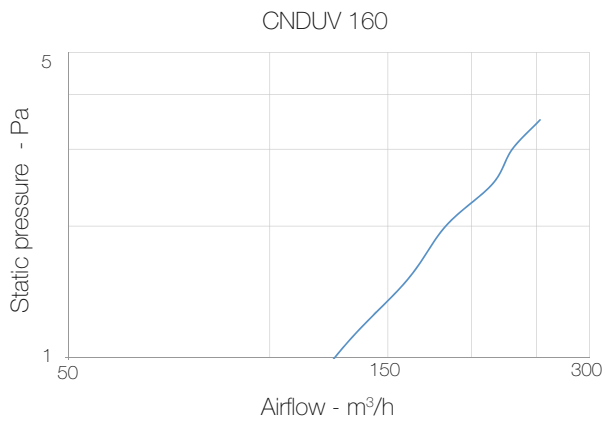

	Lw dB - SOUND POWER OCTAVE BAND								Lw dB
	63	125	250	500	1 K	2 K	4 K	8K	
CNDUV 160	40,3	41,1	34,1	22,1	13,2	5,8	13,0	20,3	26
CNDUV 200	52,1	41,9	35,2	27,4	19,6	11,7	14,6	7,1	32

Sound abatement obtained with a 2-meter length duct according to the Regulation EN-ISO 354:2003

# AQ Air Distribution



## CRVUV

90°/45° insulated twin wall bend - Rigid and corrugated outer casing in polyethylene resistant to the impacts.

Inner sheath with insulated foam, water repellent, close cell structure.

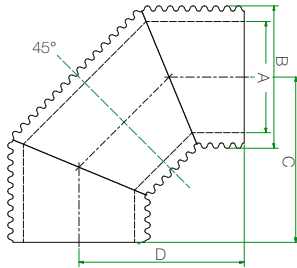

Model	CRVUV 160	CRVUV 200
Code	000079	000072
Ø A	125	170
Ø B	160	200
C	167	201
D	167	201

Dimensions in mm

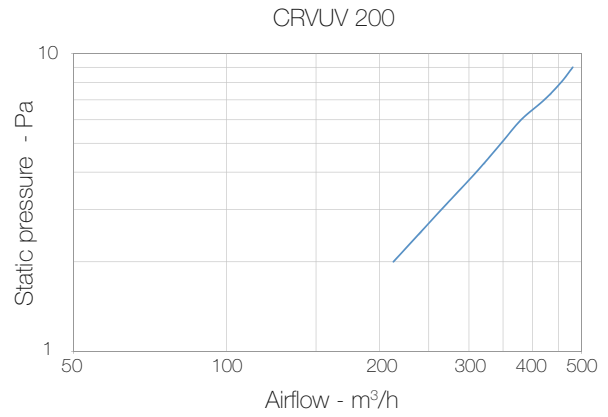
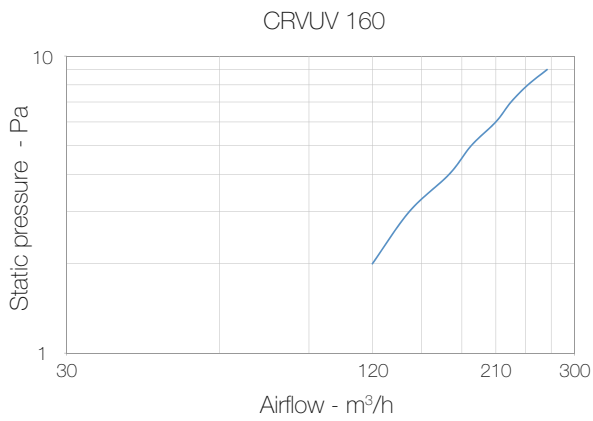

# AQ Air Distribution



## GNTUV

Straight duct connection, in EPDM, for a duct-duct or duct-bend connection, to guarantee the best grip.



Model	GNTUV 160	GNTUV 200
Code	000080	000073
Ø A	160	200

Dimensions in mm



## RDZUV

Circular reducer, in EPDM, for a duct-ventilating unit or duct-distribution plenum connection.

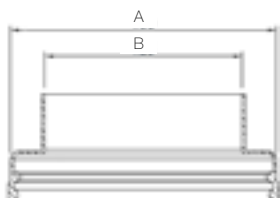

Model	RDZUV 160	RDZUV 200
Code	000081	000075
Ø A	160	200
Ø B	125	150

Dimensions in mm



## TRMEX

Roof terminal totally isolated and vapour seal, equipped with accessories for the assembly. Can be used as an external air inlet or outlet. The skull cap rain-free integrated, combined with the crossing shingles, insure its impermeability.

Flat adaptor for roof available as an accessory on request (ADTEX).

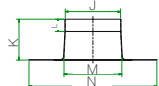
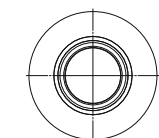
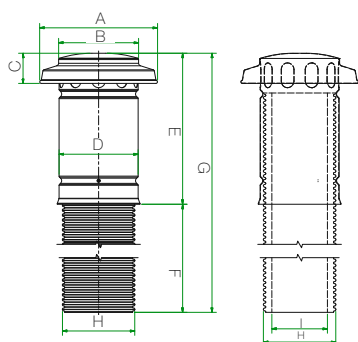

Model	TRMEX 160	TRMEX 200
Code	000083	000062
Ø A	265	300
Ø B	180	217
C	68	90
Ø D	178	212
E	340	340
F	625	665
G	965	1005
Ø H	160	200
Ø I	125	170

Model	ADTEX 160/125	ADTEX 200/170
Code	000085	000077
J	168	203
K	150	150
L	45	45
M	177	212
N	470	470

Dimensions in mm

# AQ Air Distribution



## KAM

Through-wall kit with external hood in galvanized metal sheet, finished RAL9010, with acoustic lining and telescopic pipe of 300-500mm length.

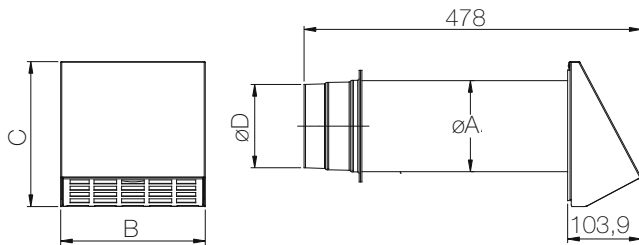

Model	KAM 125	KAM 150
Code	000513	000538
$\varnothing A$	125	150
B	255	255
C	255	255
$\varnothing D$	118	148

Dimensions in mm

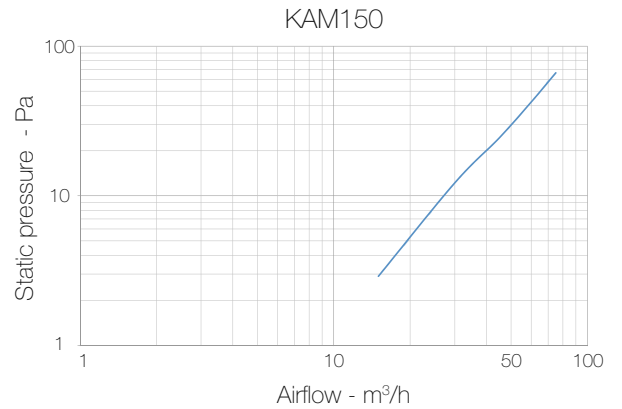
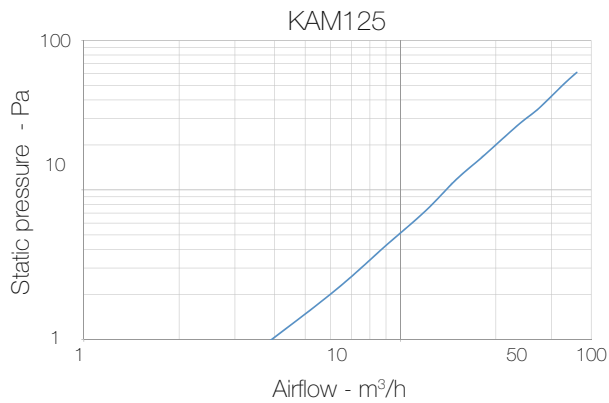

# AQ Air Distribution



## TEINX

External stainless steel bull nose vent with wire mesh, suitable for air exhaust/supply.

Model	TEINX 100	TEINX 125	TEINX 150
Code	000630	000631	000632
Ø	100	125	150

Dimensions in mm

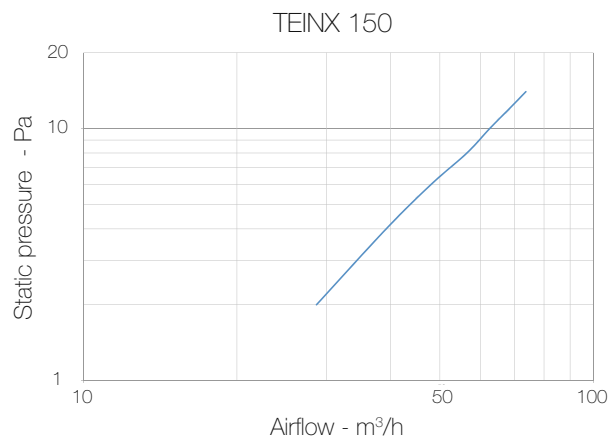
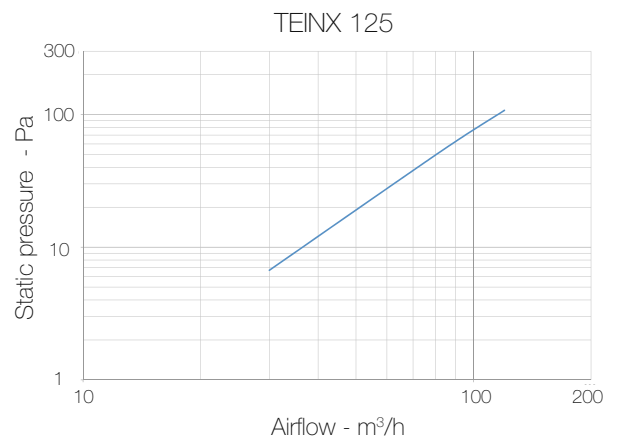
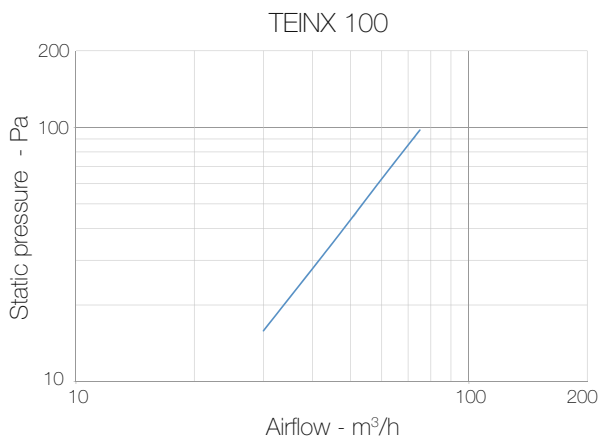

# AQ Air Distribution



## SEMI-RIGID DUCTWORK

The semi-rigid duct CNDFLB is used for the air movement from the distribution plenum up until the air inlet or outlet. Appropriate for the installation in concrete slab, false ceiling or on the wall.

**Structure** made in twin wall in high-density polyethylene (HDPE). Smooth internal side; corrugated outer casing. Supplied with sealing dust caps at its extremities to protect the internal parts during the installation. Made with virgins raw materials of high quality and **free of contaminates**, as per the Regulation D.M.N. 174

from 04/2004 and as the European Regulation EN 61386-24 guarantees:

- **Antibacterial, antimicrobial and antistatic properties;**
- **High resistance to the static charges;**
- **Strong elasticity and automatically going back to its original form**
- **Bending radius reduced**

**Antimicrobial treatment Sanitized®**, that permits a reduction of more than 99% of the bacterial charge in the internal superficies of the ducts to prevent the bacterial and fungus formation. The Zinc pyrithione, an antibacterial, prevents the creation of bad smells.

**Certifications:** developed in accordance with the tighten regulations for the ventilation and air conditioning systems. The test reports realized on the product by the well-known German Hygiene institutes HY ratify the conformity of the duct as per the following regulations: VDI 6022 (07/2011) SWKI VA104-01 (04/2006) ÖNorm H6021 (09/2003) ÖNorm H6038 (02/2014)



## Characteristics

The hygienic function efficiency for the entire life cycle of the product was tested by the Swiss laboratories Sanitized® for a large range of pathogenic germs, as the staphylococcus aureus, legionella pneumophila, pseudomonas aeruginosa and legionella pneumophila.

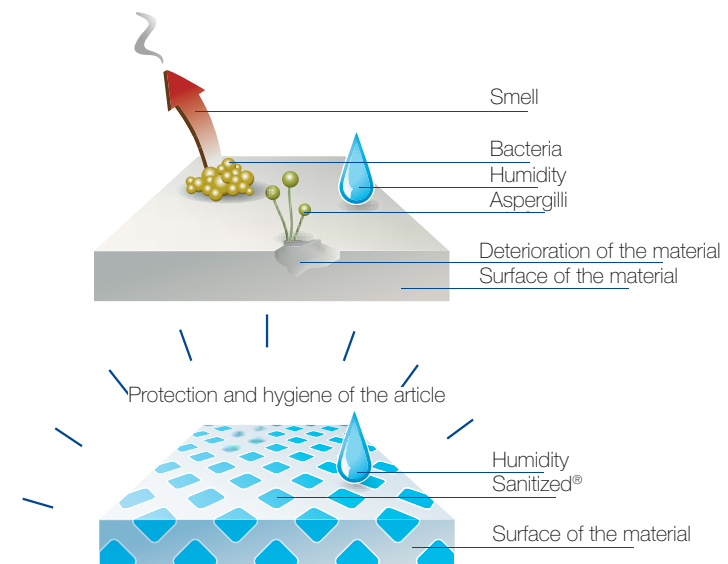

Test	Method	Percentage reduction	Certification body
ANTIBACTERIAL	ASTME 2149-10	99,6%	SANITIZED AG LYSSACHSTR.95 CH-3400 BURG DORF SWITZERLAND
	ISO 22196:2007	99,9%	
ANTIFUNGAL	EN ISO 22196:2007	NO FUNGUS DEVELOPMENT NOTICED	
ANTISTATIC	INTERNAL METHOD	96%	ABCS SRL VIA SOLAR, 32- 20144 MILAN ITALY

# AQ Air Distribution

## Dimensions

Models			CNDFLB 75/63	CNDFLB 90/75
Code			001536	001541
Material			HDPE	HDPE
External diameter		mm	75	90
Internal diameter		mm	63	76
Internal layer			antibacterial	antibacterial
			antifungal	antifungal
			antistatic	antistatic
External layer surface			self-extinguish	self-extinguish
Internal undulation			< 5%	< 5%
Weight		g/m	250	340
Length of the roll		m	50	50
Roll dimensions		External D.	113	122
		Internal D.	52	54
		Height	43	48

## Pressure drop table

Models			CNDFLB 75/63	CNDFLB 90/75
Pressure resistance		N	>450 >750	>450 <sup>a</sup>
Working temperature range		°C	-30 ÷ +60	-30 ÷ +60
Laying temperature range		°C	-5 ÷ +60	-5 ÷ +60
Minimal bending range		mm	225	270
Airflow at 2 m/s		m <sup>3</sup> /h	22,44	32,66
Pressure drop at 2 m/s				
	Rectilinear (1m)	Pa	1,04	0,99
	Bend 90°		0,79	0,87
	Bend 180°		1,30	1,32
Airflow at 2,5 m/s		m <sup>3</sup> /h	28,06	40,83
Pressure drop at 2,5 m/s				
	Rectilinear (1m)	Pa	1,62	1,54
	Bend 90°		1,24	1,35
	Bend 180°		2,03	2,07
Airflow at 3 m/s		m <sup>3</sup> /h	33,67	48,99
Pressure drop at 3 m/s				
	Rectilinear (1m)	Pa	2,33	2,22
	Bend 90°		1,79	1,95
	Bend 180°		2,93	2,98

# AQ Air Distribution



## KGNFLB

Connection for joints CNDFLB ducts.  
Sealing rings included.

Model	KGNFLB 75/63	KGNFLB 90/75
Code	001537	001542
Ø	75	90

Dimensions in mm



## KCRVFLB

90° vertical bend for CNDFLB 75/63 duct.  
Sealing rings included.

Model	KCRVFLB
Code	001538

Dimensions in mm



## KCLFLB

Handy fixing system to ease the CNDFLB duct positioning at the construction site. The clips, which can also be used in pair, allow the ducts to be neatly mounted in parallel: they keep the semi-rigid pipes well positioned up until they are covered by the screed or by the false ceiling panels. They are available in two colours (red and blue) to distinguish the airflow direction.

Model	KCLFLB 75/63 BLU	KCLFLB 75/63 ROSSO	KCLFLB 90/75 BLU	KCLFLB 90/75 ROSSO
Code	001539	001540	001543	001544
Ø	75	75	90	90

Dimensions in mm



## PLMP 150 2x125 - PLML 150 2x125

Distribution plenum in galvanised steel with acoustic lining, easy to inspect.  
1 inlet Ø150mm - 2 rear (PLMP) or side (PLML) outlets Ø125mm.

Model	PLMP 150 2x125	PLML 150 2x125
Code	000575	000580

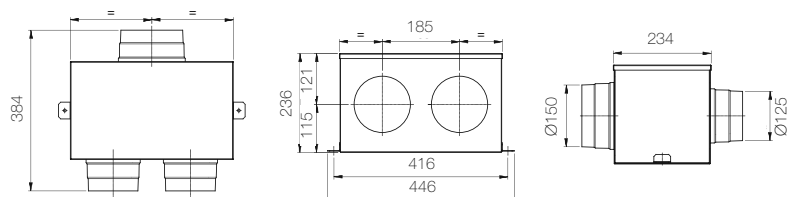

Dimensions in mm

## PLMP 150 2x125

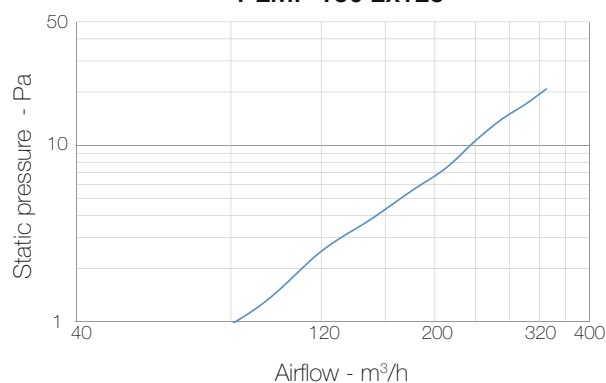

# AQ Air Distribution

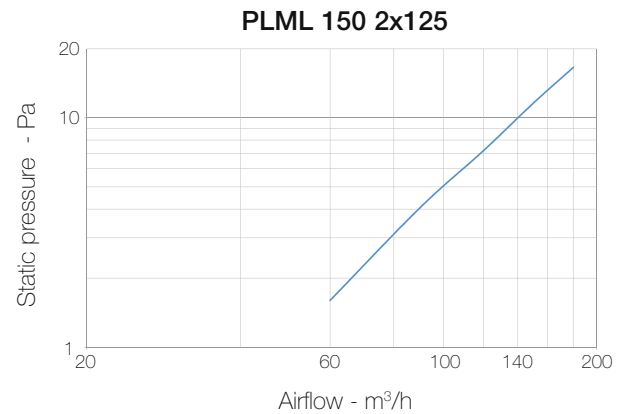
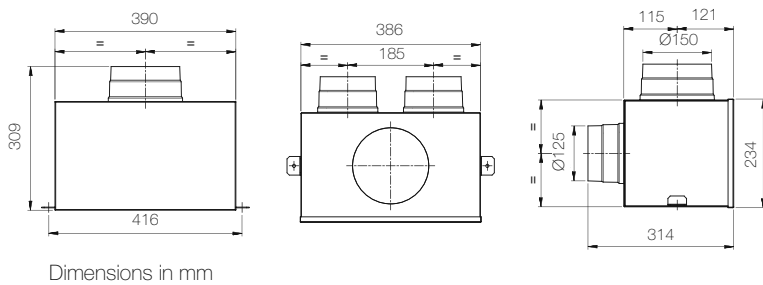

## PLMP 125 6x75

Distribution plenum in galvanised steel with acoustic lining, easy to inspect.  
1 inlet Ø125mm - 6 rear outlets Ø80mm (suitable for semi-rigid duct CNDFLB 75/63) - 3 caps.

Model	PLMP 125 6x75
Code	000002

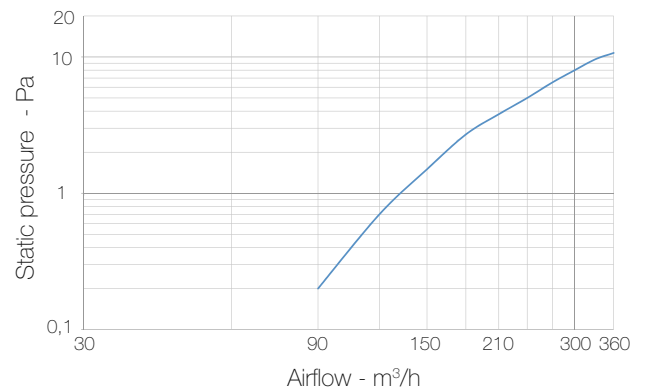
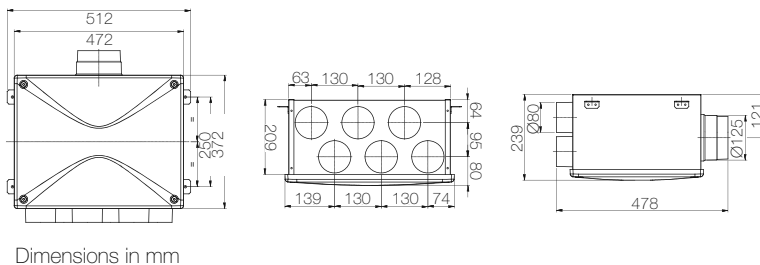

## PLMP 125 7x90

Distribution plenum in galvanised steel with acoustic lining, easy to inspect.  
1 inlet Ø125mm - 7 rear outlets Ø100mm (suitable for semi-rigid duct CNDFLB 90/75) - 3 caps.

Model	PLMP 125 7x90
Code	001480

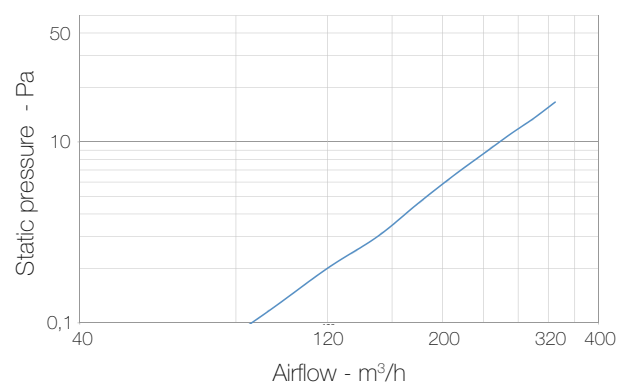
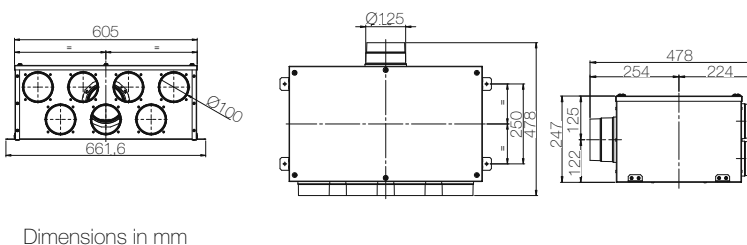

# AQ Air Distribution



## PLMP 125 10x75

Distribution plenum in galvanised steel with acoustic lining, easy to inspect.  
1 inlet  $\text{\O}125\text{mm}$  - 10 rear outlets  $\text{\O}80\text{mm}$  (suitable for semi-rigid duct CNDFLB 75/63) - 5 caps.

Model	PLMP 125 10x75
Code	001406

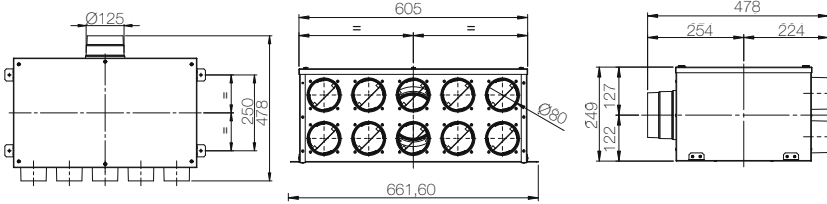

Dimensions in mm

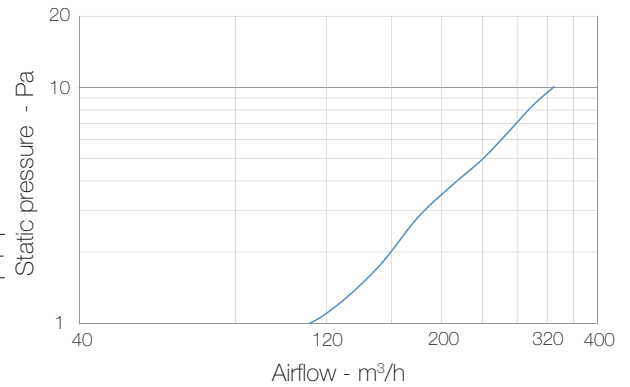

## PLMP 150 10x75

Distribution plenum in galvanised steel with acoustic lining, easy to inspect.  
1 inlet  $\text{\O}150\text{mm}$  - 10 rear outlets  $\text{\O}80\text{mm}$  (suitable for semi-rigid duct CNDFLB 75/63) - 5 caps.

Model	PLMP 150 10x75
Code	000003

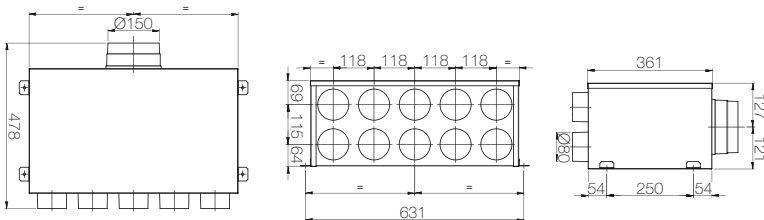

Dimensions in mm

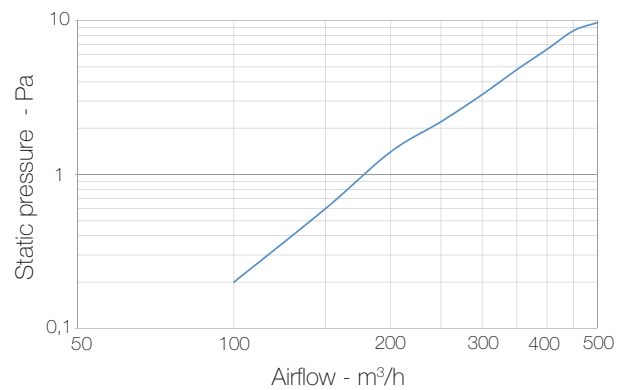

## PLMP 150 11x90

Distribution plenum in galvanised steel with acoustic lining, easy to inspect.  
1 inlet  $\text{\O}150\text{mm}$  - 11 rear outlets  $\text{\O}100\text{mm}$  (suitable for semi-rigid duct CNDFLB 75/63) - 5 caps.

Model	PLMP 150 11x90
Code	001546

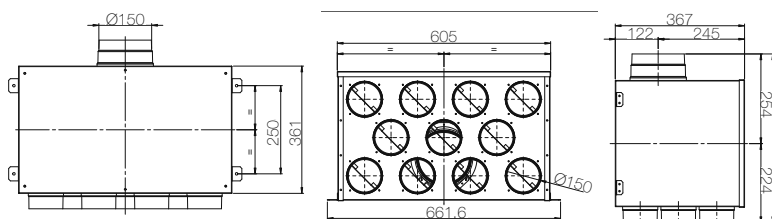

Dimensions in mm

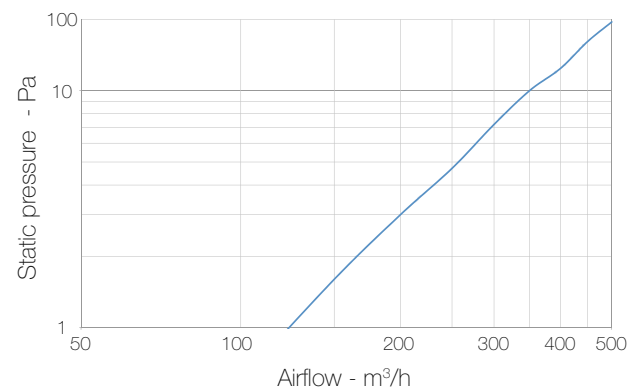

# AQ Air Distribution



## PLMP 150 15x75

Distribution plenum in galvanised steel with acoustic lining, easy to inspect.  
1 inlet  $\varnothing 150\text{mm}$  - 15 rear outlets  $\varnothing 80\text{mm}$  (suitable for semi-rigid duct CNDFLB 75/63) - 7 caps.

Model	PLMP 150 15x75
Code	000004

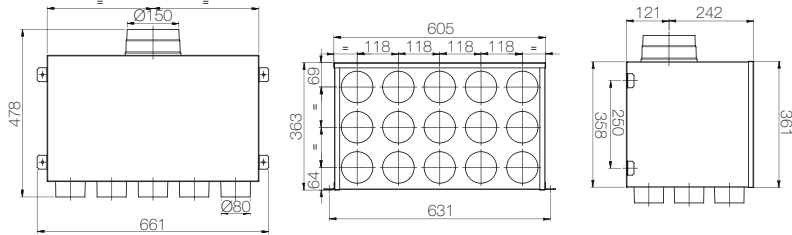

Dimensions in mm

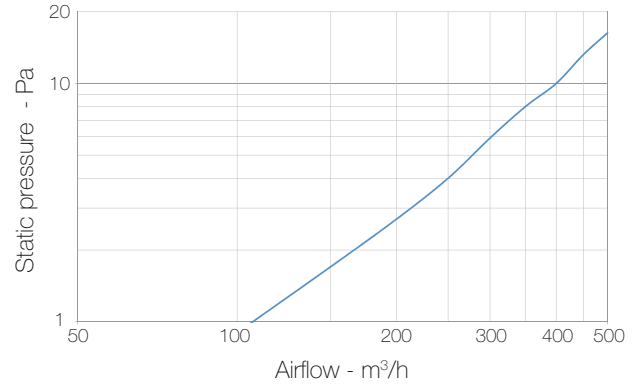

## KORB

Set of sealing rings for round duct.

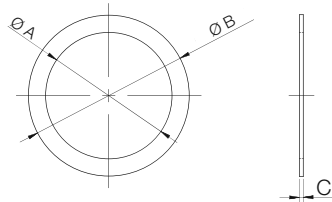

Model	KORB 75	KORB 90
Code	000060	001545
$\varnothing A$	64	78
$\varnothing B$	81,5	92,5
C	2	2

Dimensions in mm



## KTAP

Set of plastic caps to close the non-used spigot or to protect them from dust.

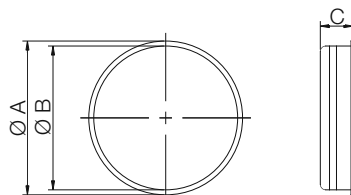

Model	KTAP 75	KTAP 90
Code	CPP00008	001623
$\varnothing A$	85	99
$\varnothing B$	79,5	96,5
C	18	19

Dimensions in mm