

## features & benefits

### Mixed flow fan for duct mounting

For apartments, hotels, bathroom, utility or kitchen  
Shockproof, heat resistant ABS UV resistant plastic,  
finished in white (RAL 9010)

Two speed high, low operation and off switch

Single phase 220V to 240V 50Hz or 60Hz

# HIMF

## Mixed Flow Fan

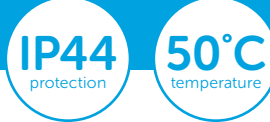

## curves

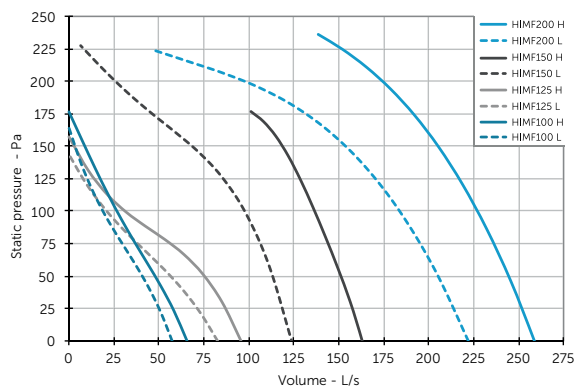

## dimensional drawing

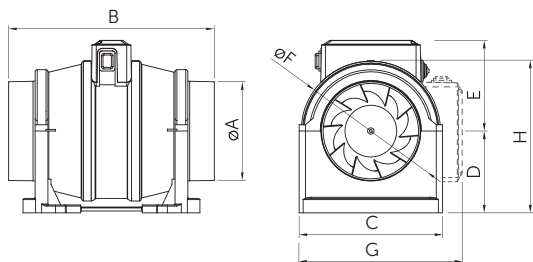

## dimen...

	100	125	150	200
øA	97	124	147	198
B	296	256	298	310
C	179	179	194	254
D	104	102	109	129
E	113	113	127	146
øF	174	174	195	228
G	202	202	223	272
H	190	190	211	243
Weight (kg)	2.4	2.4	3.0	4.0

Dimensions in mm.

## product information

		HIMF			
		100	125	150	200
Airflow (L/s) max	High	65.6	95.7	163.2	258.9
	Low	57.4	82.6	124.4	222.3
Static Pressure (Pa) max	High	176	157	176	236
	Low	164	143	227	223
Power (W) max	High	32	34	69	120
	Low	32	33	58	106
Sound Pressure (dBA @ 3m)	High	45	44	55	53
	Low	44	43	50	51

## accessories

	100	125
Fixed Grille	HEG100	HEG125
External Gravity Shutters	HES100	HES125
Internal Extract Valve	HEV100	HEV125
Internal Supply Valve	HSV100	HSV125
3m Flexible Aluminium Duct	HFD100X3	HFD125X3
	150	200
Fixed Grille	HEG150	
External Gravity Shutters	HES150	
Internal Extract Valve	HEV150	HEV200
Internal Supply Valve	HSV150	HSV200
3m Flexible Aluminium Duct	HFD150X3	HFD200X3

## HIMF with easi cable



Ready to run EASI models, supplied with 1.5 metres of flexible cable, two speed high / low & off switch, and fitted with a 13amp 3 pin plug.