

Installing Ceiling Roses

Adhesives:

We strongly recommend that you use our adhesives. They have been developed specifically for use with the range. Other bonding agents may not be chemically compatible with the product range and may provide inadequate adhesion or fusion.

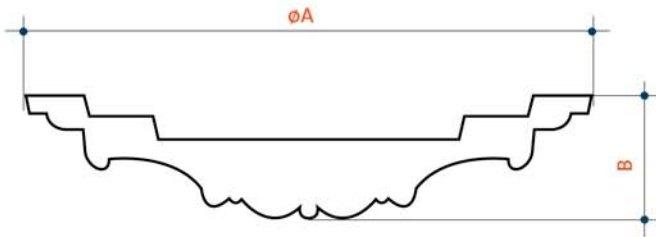

The dimensions given for each moulding are based on averages, and may vary slightly. Check measurements at job site before installing.

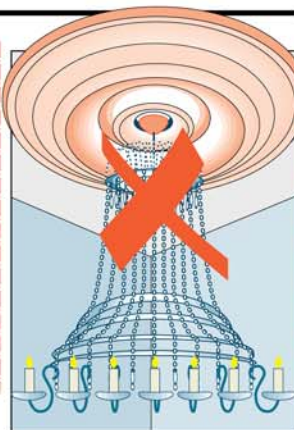
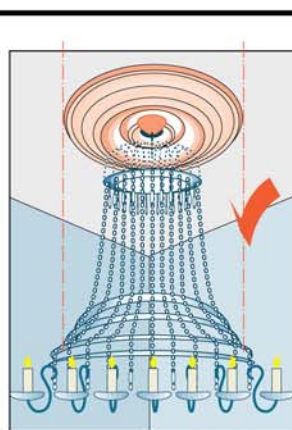
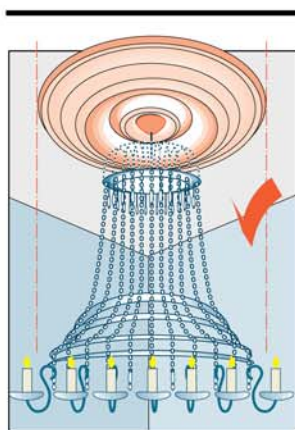
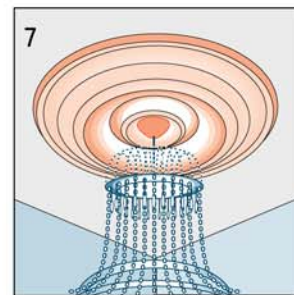
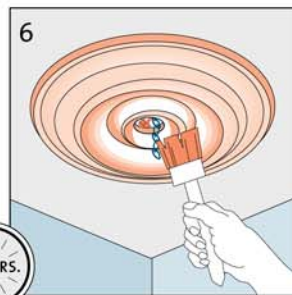
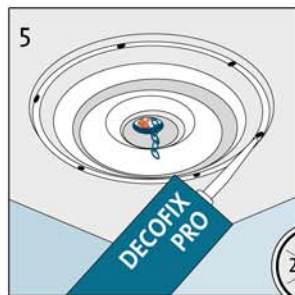
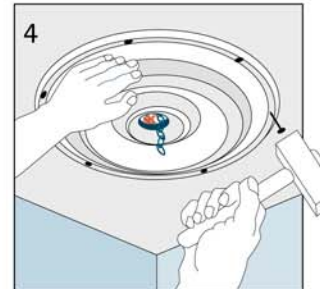
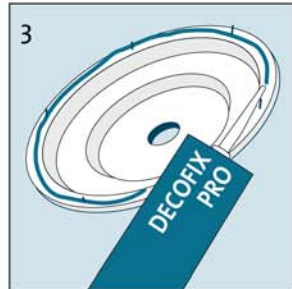
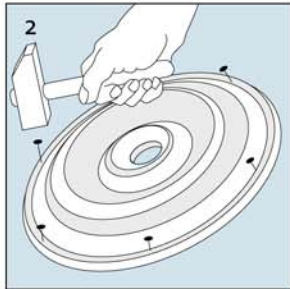
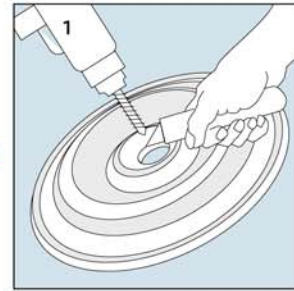
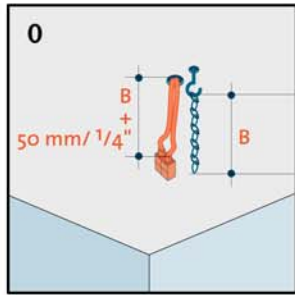

Finishing

These products are pre-primed. They are best finished with high quality flat satin or full gloss oil-based or latex paint.