

# Atlas Pro

## EXPOSED SHOWER VALVE



<b>Product Code</b>	<b>SHWRPKSPA1</b>
<b>Operating pressure</b>	0.2 to 10
<b>Material</b>	Stainless steel, polyester
<b>Colour</b>	Chrome

### Description:

This exposed valve has been developed by adopting the principles of inclusive design. Suitable for any user, regardless of their sight or dexterity

### Key features:

- Sequential control shower valve for combined control of temperature and flow
- Single piece thermal cartridge technology
- Factory set at 41°C to prevent scalding
- Fail safe on hot and cold supplies
- Operating pressure range of 0.2 to 5 bar
- TMV3 scheme approved
- Complies with HTM64

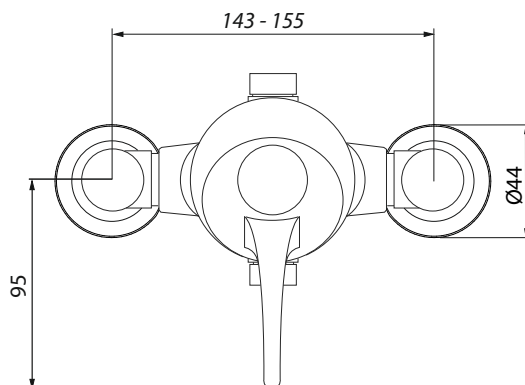

Outlet Temperature Adjustment Range	30°C to 50°C
Temperature Stability	±2°C
Maximum Hot Inlet Temperature	85°C
Inlet Temperature Range	52°C to 65°C : Hot Supply 5°C to 20°C : Cold Supply
Max. Working Pressure	10 bar : Static
Min. Working Pressure	0.2 bar : Dynamic
DO8 Working Pressure Range	0.2 to 1.0 bar : Low Pressure 1.0 to 5.0 bar : High Pressure
Min Temp Differential (Mix to Hot) for Fail-Safe	10°C
Max. Pressure Inlet Differential	5 : 1
Max. Flow Rate @ 1 bar Differential	<div> <div> Ø15mm Ø22mm </div> <div> 1500l/h 1700 l/h </div> <div> (25l/m) (28.3 l/m) </div> </div>

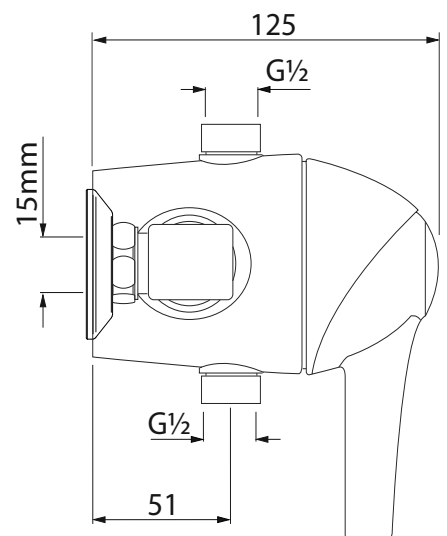

All dimensions are approximate and subject to normal ceramic variation. Although every effort is made not to change the above product specification, Lecico reserve the right to do so without prior notification if necessary. Against manufacturers defects. Full information on guarantees available upon request.