

# Atlas Pro

## GRAB RAIL - 450MM



<b>Product Code</b>	<b>DGRAIL45**</b>
<b>Weight (Kg)</b>	0.8
<b>Material</b>	Steel
<b>Colour Options</b>	Blue, Grey, White

**Blue:** DGRAIL45DB

**White:** DGRAIL45W



RAL5011  
LRV - 5.52



RAL9016  
LRV - 87.67

### Key features:

- Doc M compliant
- Robust steel construction
- Durable epoxy polyester coated finish

### Description:

This straight Doc M compliant grab rail is essential for any disabled area and has been designed with a durable epoxy polyester coated finish and is available in two sizes: 450mm and 600mm.

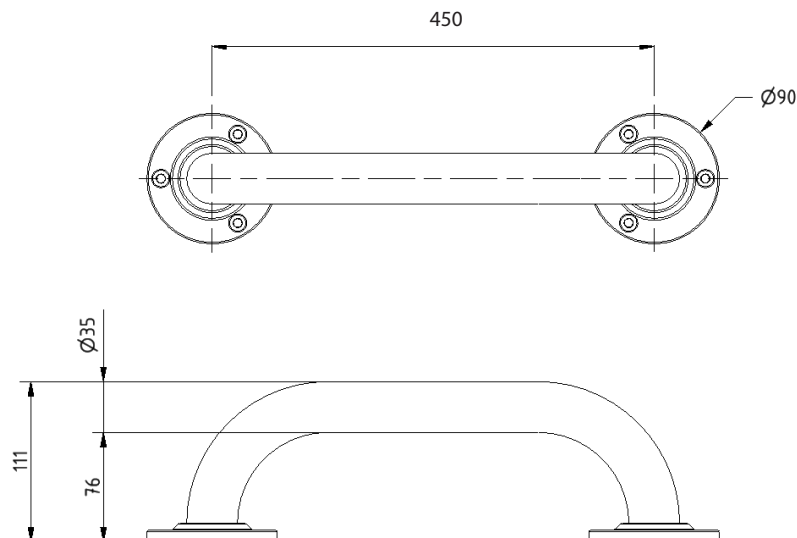

All dimensions are approximate and subject to normal ceramic variation. Although every effort is made not to change the above product specification, Lecico reserve the right to do so without prior notification if necessary. \*Against manufacturers defects. Full information on guarantees available upon request.