

ATLAS PROFESSIONAL COLLECTION

CONCEALED CISTERN DIMPLE

LEVER WITH EXTENDED FLUSH PIPE

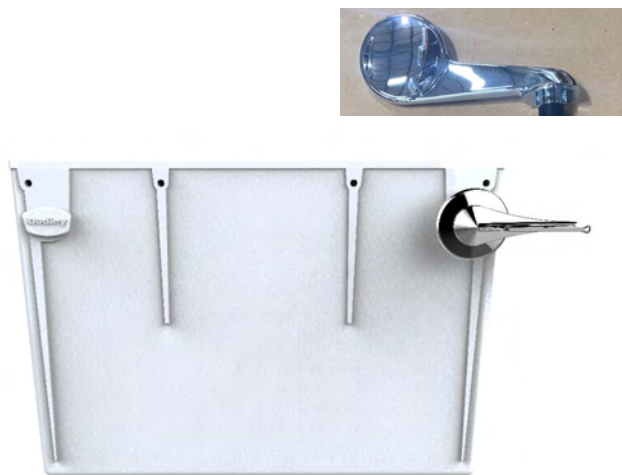

Product Code	BTWPHACIDOCE
Flushing Volume (Ltr)	4/2.6
Weight (Kg)	2.9
Cistern fittings included	Yes
Pre-installed/Bagged	Pre-installed
Material	Mixed Plastics
Flushing Mechanism	Dual Flush Lever
Inlet	RH or LH Bottom Inlet
Access	Top

- Key features:**
- Chrome effect lever (dimple lever on DocM variant)
 - Polystyrene high density cistern body
 - WRAS approved

Description:

Ideal for use behind tiles and partitioning and in most other concealed applications. Factory assembled for quick and easy installation. This cistern is available for use with our DocM 750mm projection WC's. This is supplied with extended flush pipe and dimple lever.

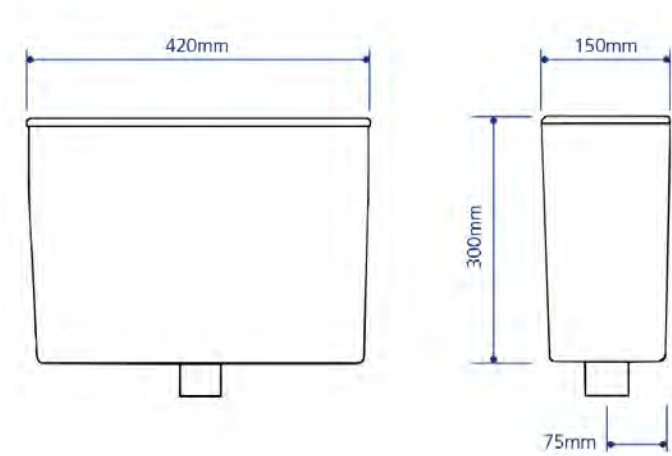

All dimensions are approximate and subject to normal variation. Although every effort is made not to change the above product specification, Lecico reserve the right to do so without prior notification if necessary. Full information on guarantees available upon request.