



WE LOVE SHOREDITCH PARK

During October 2019 over 1,600 local people and park users took part in the public consultation to improve Shoreditch Park. You told us what to protect, what to change, and how to create a Park that works for the local community. We listened to what you told us and your ideas and feedback helped shape our design proposals to improve Shoreditch Park.

We hope you enjoy seeing the designs for your improved Park. We'd love to hear what you think of them and whether you think we have created a park that works for the whole community.



Proposed Improvements

Boundaries improved and new entrances created across the Park

Increased biodiversity and wildlife habitats across the Park - see page 6



Wildflower planting and seating around the boulder

Playground completely redesigned with new equipment, more trees and benches - see page 8

New sports hub, outdoor gym, MUGA and tree plaza - see page 4

Improvements to Bridport Place - see page 10

Improvements to the informal sports pitches

New entrance to the Adventure Playground and improvements to the perimeter fence

New toilets and cafe, improvement works to Grange Street, and a new public square as part of the Britannia Leisure Centre Redevelopment

Improvements to Dorothy Thurtle Gardens - see page 11

- New Park Entrances
- Existing Park Entrances
- - - Existing railings retained
- - - Existing railings removed
- New benches
- All sculptural/artistic/memorial benches retained
- New trees

Improvements across the Park

What you told us:

You love Shoreditch Park and the large, open grassed areas for running around, dog walking, playing sports, riding bikes, and socialising with friends and family. You gave us lots of specific suggestions for improving the Park, but above all, you asked us to protect the sense of space.

Other priorities you had were improving the condition of the grassed areas and planting more trees, wildflowers, and hedgerows to improve biodiversity and soundproof noise from New North Road. Large numbers of you told us you'd like more benches, community and social spaces, outdoor gym equipment, more facilities for sports, and a new and more exciting play area with a tower and more swings. The masterplan gives an overview of the new layout of Shoreditch Park, but detail about the improvements we are making to each area of the Park can be found in the brochure.

Proposed Improvements

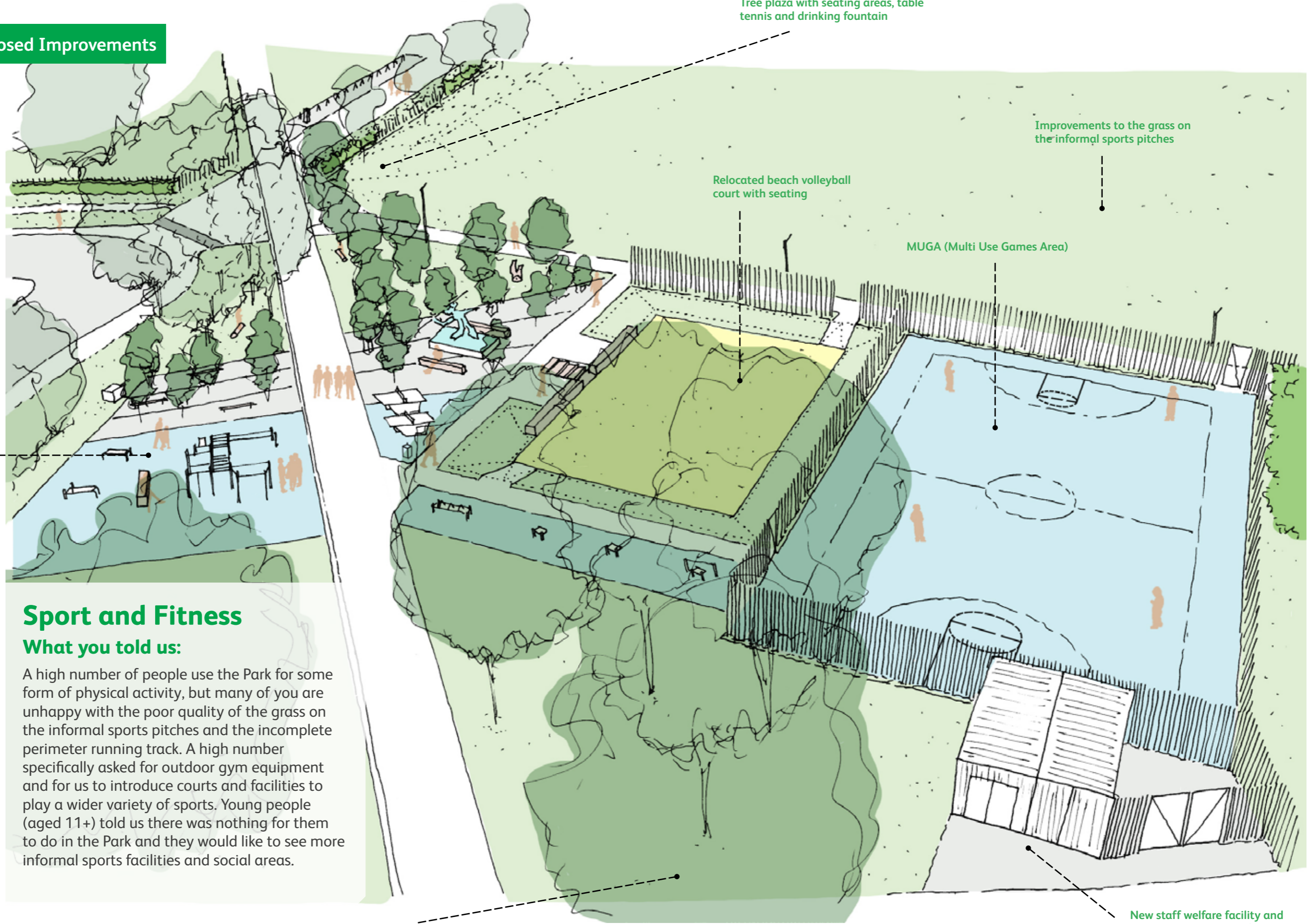

Outdoor gym with multi use calisthenics equipment

Tree plaza with seating areas, table tennis and drinking fountain

Improvements to the grass on the informal sports pitches

Relocated beach volleyball court with seating

MUGA (Multi Use Games Area)

Sport and Fitness

What you told us:

A high number of people use the Park for some form of physical activity, but many of you are unhappy with the poor quality of the grass on the informal sports pitches and the incomplete perimeter running track. A high number specifically asked for outdoor gym equipment and for us to introduce courts and facilities to play a wider variety of sports. Young people (aged 11+) told us there was nothing for them to do in the Park and they would like to see more informal sports facilities and social areas.

A continuous running track of 1.3km (0.75miles) to the outer edge of the Park

New staff welfare facility and green waste compound



Proposed Improvements

Wildlife, Nature and Biodiversity

What you told us:

You told us that wildlife, trees, wild grass areas, and having access to such a large area of open and green space were things you enjoyed most about the Park. Many of you told us you wanted more trees and planting to improve biodiversity, absorb pollution, create more shady quiet areas, assist with the effects of climate change, encourage more wildlife, and soundproof noise from New North Road. You also told us you wanted the Park to feel wilder so that it was more interesting to explore, and for there to be more opportunities for people to interact with nature.



-  50+ new trees in Dorothy Thurtle Gardens, play area and new tree plaza
-  Log piles introduced across the Park
-  UK native hedgerow along New North Road and around Adventure Playground and play area
-  Mown paths and edges
-  Rain gardens with seasonal swale and marginal planting along Bridport Place
-  Wildflower meadows in Dorothy Thurtle Gardens and around the rock
-  Relaxed grass mowing and overseeded in Dorothy Thurtle Gardens, along New North Road and Rushton Street
- Bat and bird boxes across the Park
- More trees of mixed UK native species across the Park, a new tree plaza in the heart of the Park and orchard trees in the play area

Play and Discovery

What you told us:

Children, young people, their families and general visitors to the Park told us the play area was one of their favourite things about Shoreditch Park, but that the equipment needed updating. Many of you told us you would like the play equipment to be suitable for slightly older children and for the sense of play to spill out into the Park for families, older children and young people.



New playable trail from Dorothy Thurtle Gardens to the play area

Proposed Improvements

A tower and a mound with wheelchair access

Cradle swing retained

Existing fence to play area pushed back from Rushton St

New entrance from Rushton street



More trees, shade and seating areas throughout the play area

All play equipment replaced with timber based equipment

Sand pit with bucket hoists

More swings

Orchard trees and boulders to sit on

Rushton Street

Bridport Place

What you told us:

Many of you enjoy being able to cycle and hire bikes from within the Park, and find it a great park for children to learn to ride their bike, but a high number also expressed concern about the speed and poor attitude of some cyclists using it as a cut through and commuter route.

To address these issues we will be narrowing Bridport Place to make it feel less like a cut-through road, adding rumble strips to problem paths and creating a chicane down Bridport Place to slow cyclists down.

Proposed Improvements

Bridport Place resurfaced and narrowed with a chicane to slow down cyclists

Rain garden planting and a seasonal swale drainage channel filled with run off from the MUGA (Multi Use Games Area)



Children's play area

Leading to a tree plaza with seating and a drinking fountain at the heart of the Park

Dorothy Thurtle Gardens

What you told us:

A high number of you told us you loved Dorothy Thurtle Gardens as a place to relax and read a book and you also enjoyed the planting.

Many also told us that they didn't always feel safe in this area of the Park because of the dead corners, hiding spaces and how cut off it was from the surrounding area.

You liked the mound, but told us the path needed improving.

Proposed Improvements

New playable trail leading from Dorothy Thurtle Gardens to the play area

New path over the mound

Opening up dead corners and hiding spaces within the gardens to make the Park feel safer

Railings removed from the edge to open up the Park to the surrounding area infilled with stone boulders and logs to prevent vehicles.

New trees, relaxed grass and wildflower planting throughout the Garden



Two new entrances to make the Gardens feel safer and welcoming

“Shoreditch Park is an oasis in a densely populated urban area”

“This Park has a special place in my heart”

Other things you told us...

Signage

Many of you find the footpath networks confusing and you would like to see more signage - both directional and informational. We will use artistic interventions to animate the space, this will include welcome signage to key Park entrances, interpretation material on seating and inlaid within the ground, narrative features within the playground, and the use of a colour theme throughout.

Safety

Across the consultation you told us your concerns about crime and safety in the Park and how it didn't feel safe after dark. Many of you told us your ideas for how issues could be resolved or improved, including additional lighting, the presence of maintenance staff on site, and by making it a more popular and attractive place to visit. The existing lighting will be repaired where required, and we are investigating lighting to the sports hub area to allow evening use. This could include manually operated lights, movement sensors, low-energy fittings and a timed cut-off, however the impact on the ecology of the Park also needs to be considered in the discussions on the introduction of further lighting. We are also opening up dead corners and hiding spaces within Dorothy Thurtle Gardens to make the Park feel safer to use in the evening.

Facilities, benches and bins

We will be upgrading the bins and adding a variety of new seating areas across the Park including long wide flat benches for groups and seats with back and armrests for older people. A new café and toilet facilities will be provided as part of Britannia Leisure Centre and will be easily accessible from the Park.

Events and Activities

People told us they enjoyed attending fun fairs, sports days and the play bus, and about how they used the Park for family picnics and playing games, but people also told us about the negative impact of official and unofficial events and activities in the Park causing litter, antisocial behaviour and noise for local residents. Some suggested specific events and activities they would like to be able to do in the Park in the future including attending musical performances, theatre, outdoor cinemas, school productions and community events within the Park.

“It's the best Park in Hackney”

“It's my local park, I love it, but it needs a heart”

“I love the openness and sense of space in Shoreditch Park, please protect that”

Improving the grass

Across the consultation joggers, dog walkers, families, and people who play sports highlighted the poor condition of the grass and potholes on the informal sports pitches and open grassed areas. We are investigating with a soil specialist the issues concerning soil depth and quality across the sports pitch to explore opportunities for improvement. These proposals could have a significant cost attached to them which could take a large portion of the budget, so they would need to be carefully reviewed against the other proposals.

Dogs

Many of you love being able to walk your dogs in the Park, but others feel their experience is impacted negatively by the presence of dogs for a number of reasons, including dog mess, dogs running freely off the lead, and dogs not adequately controlled by their owners. This is always a difficult issue to balance because there are always strong arguments for and against dogs in parks. We don't believe Shoreditch Park is big enough to have a separate dog area and these areas can also create other problems. To address the issue of dogs we will be keeping the playground fenced and dog-free and providing more bins across the Park that allow dog-poo bags.

Boundaries and Entrances

Many of you told us about specific entrances that felt unwelcoming and how specific boundaries would benefit from being blurred with the road. We are creating new entrances to make it easier to access the play area and Dorothy Thurtle Gardens and introducing signage at the key entrances to make them feel more welcoming. To open the Park up to the surrounding areas we will be removing railings from Dorothy Thurtle Gardens and along Poole Street and Bridport Place. Where the Park needs more protection from the New North Road we will be planting additional hedgerows and pushing the boundary fence of the play area further into the Park and away from the road.

Community and Gathering

A high number of respondents commented on the diverse activities and events currently available in the Park, that provide an opportunity for communities and families to gather. There is a desire to make improvements to the Park to enhance the sense of community for the surrounding area, by creating better communal facilities and spaces to facilitate community events.

A new public square outside new Britannia Leisure Centre

We would like local residents to help us decide the name of a new public square outside the new Britannia Leisure Centre. We have narrowed it down to four names that celebrate important people, places and events that are linked to the history of Hoxton and Shoreditch. Discover the history behind the names here and vote for your favourite online or using the attached questionnaire.



Bradlaugh Square

Born in Hoxton in 1833, Charles Bradlaugh was a political activist, atheist, freethinker, an advocate of trade unionism, and a supporter of universal suffrage. He was President of the London Secular Society from 1858 and in 1866, co-founded the National Secular Society, where he edited the secularist newspaper the National Reformer, and where local women's rights activist Annie Besant became his close associate. In 1868, the Reformer was prosecuted by the British Government for blasphemy and sedition.

Bradlaugh was eventually acquitted on all charges. In 1876 Bradlaugh and Besant republished The Fruits of Philosophy, an American pamphlet advocating birth control, and, as a result both activists were tried for obscenity. Bradlaugh was born 5mins away from the new public square at 5 Bacchus Walk, where a brown plaque commemorates him.

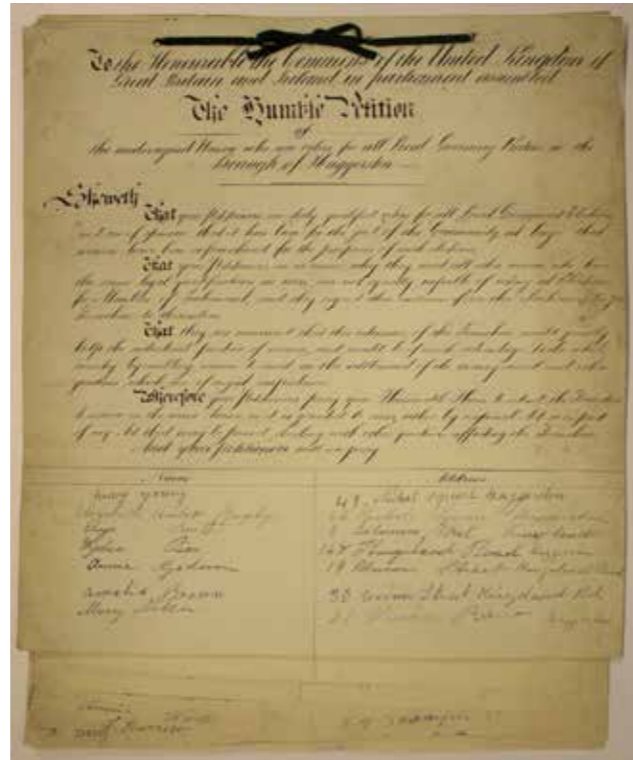

Humble Square

In c.1900-1910 Haggerston residents signed a petition asking for women to be given the right to vote in parliamentary elections. At least 10 of the 279 people who signed the petition lived on and around the site of the new Leisure Centre. A large number of people signed The Humble Petition with an 'X'.

It is widely believed that the people who signed with an 'X' could not write their name, and suggests that many local women at this time did not have access to an education. Despite this, they clearly still wished to have their views represented in national government.



BRAFA Square

In a BBC news report in 1984, news of the worst famine to hit Ethiopia in a century reached the UK. From the offices of The Voice newspaper on Mare Street, local musician Leon Leiffer telephoned reggae artists, musicians and MCs, to ask for their help to raise money.

A few months later, in West London, Bob Geldof and Midge Ure launched Band Aid, a project bringing together famous musicians to record and release 'Do They Know it's Christmas'. Frustrated by the lack of African heritage artists in the Band Aid and Live Aid line up, Leon Leiffer formed the British Reggae Artists Famine Appeal Team (BRAFA) with Courtney Carr, Ras Elroy Bailey, Tony Douglas, Raymond Dangarembizi and Gene Rondo, who co-wrote the charity single and lived in Hyde Road, next to the site of the new public square.

The BBC helped with the call out, Eddie Grant offered his Recording Studio for free, and in February 1985, 200 reggae artists, musicians and MCs, including Aswad, The Blackstones, Dennis Brown, Janet Kay, Winston Reedy, Trevor Walters and members of the public who sang on the backing track, turned up to record 'Let's Make Africa Green Again'.

Released by Island Records in 1985 and launched at a large open air concert in Shoreditch Park the following year, BRAFA raised over £8,000 for Save the Children to support those suffering in Ethiopia.



McKay Square

Claude McKay (1889-1948) was a Jamaican socialist, writer, poet and activist. He lived in London from 1919-1921 where he spent much of his time at the International Socialist Club in Shoreditch working to complete and publish a collection of poetry.

Reflecting on his time in London, McKay wrote that he did not think that he could have survived his time in the capital without the "freedom" provided by this space. McKay's poems celebrated Jamaican culture and brought awareness to the racist treatment that many African Caribbean individuals faced, from a queer Black perspective. His were the first poems to be published in Jamaican patois. During his time in London he also wrote for and edited Sylvia Pankhurst's newspaper the Workers Dreadnought.

How to have your say

The views and ideas of local people and park users helped to guide and shape our design proposals for Shoreditch Park.

We'd love to hear what you think about the designs and whether you feel we have created a park that works for the whole community.

Go online to view the designs, find out more information, and fill in the questionnaire: shoreditchpark.commonplace.is or return the questionnaire in the Freepost envelope provided.

Have your say by the **11th November 2020**.



For more information:

Visit: www.hackney.gov.uk/shoreditch-park

Email: consultation@hackney.gov.uk

Call **020 8356 3000**

