

# HS2

## HS2 Update 01 December 2020

# Planned engagement for 2021

We are working with our contractors to put in place our engagement plan for next year; to ensure that we are sharing information regularly, through a range of formats, and enabling opportunities for members of the community to ask us questions, in line with the local engagement plan.

## **New / restarted routine engagement in 2021**

- Construction look aheads published quarterly covering the next three months. These will also include a less detailed look ahead for work over the next 12 months (first publication 1 December 2020).
- Regular Camden wide newsletters delivered to residents; to include:
  - Outline of upcoming works and events – including help promote the quarterly construction look aheads;
  - Local projects; and
  - Signposting to further information (including noise insulation, skills education and employment activities, and community investment programmes, other organisations' information – such as Network Rail).
- (While Covid restrictions continue) – monthly interactive virtual engagement opportunities (webinars and virtual drop-ins) on a range of topics.
- (When Covid restrictions end) – monthly physical drop-ins / surgeries and topic specific talks.



# Engagement updates

**Further engagement projects are being scheduled at the moment. These will include:**

Specific topic or planned works will receive dedicated engagement / communications programmes. For example, dedicated engagement around the construction skills centre at the proposed worker accommodation site on the former Maria Fidelis school playground.

## **Review of the Local Area Engagement Plan underway**

Review focused on updating technical detail, personnel and contact information. Contact group input to be sought.

## **Website update**

In order to improve the quality of our online offering, HS2 is transferring the HS2 in Camden (and all its other local sites) from Commonplace to its own systems. No functionality or information will be lost, however we hope that it will enable us to implement more functionality such as an interactive map of HS2 works in the area and improve usability.

## **Post-Covid and inclusivity**

Following a return to normality (hopefully) in 2021, HS2 intends to keep using some of the digital engagement tools and practices developed during 2020 to ensure a range of options for people to engage in a manner that is convenient and suitable for them. When a clearer timescale is available regarding end of restrictions, we will contact the working groups and other representative groups with to establish the best balance of tools to use going forward.

All engagement team members are receiving EDI and vulnerable people training.

---

# HS2

## SCS ECRG Update

# Adelaide Road Vent Shaft – works update

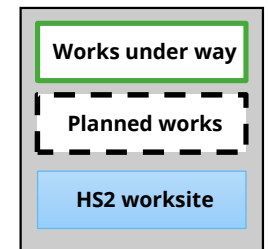
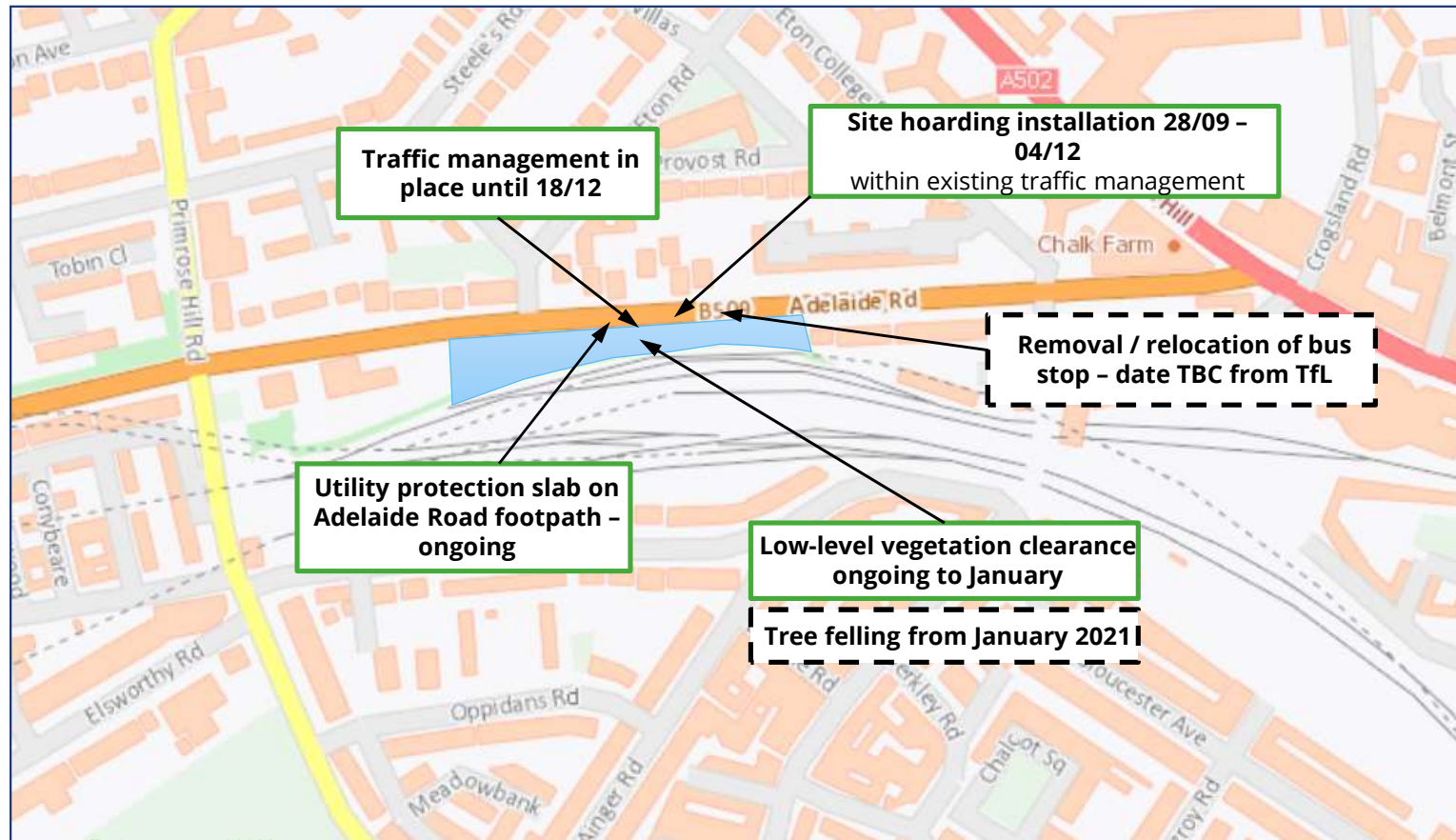

## SCS Euston Approaches – summary of road works

	Start	Finish
<b>1. Vehicle holding area (inc Prince Albert Road and Parkway)</b>		
• Prince Albert Road lane and footpath closure (4 weeks)   utilities connection works	<i>Underway</i> 02/11/2020	27/11/2020
• Parkway utility trial hole surveys (Delancey Street and Parkway footway and carriageways works)	30/11/2020	23/02/2021
<b>2. Park Village East</b>		
• Park Village East hoarding to accommodate substation   lane, footpath closures and parking bay suspensions	<i>Underway</i> 16/11/2020	27/11/2020
• GPR surveys   phased lane, footpath closures and parking bay suspensions	30/11/2020	07/12/2020
• Trial hole surveys on Mornington Street bridge   footpath closures	07/12/2020	18/12/2020
• Trial holes and parapet wall removal behind hoarding   footpath closures	30/11/2020	18/12/2020
<b>3. Regent's Park estate (inc Hampstead Road west-side)</b>		
• Hampstead Road worksite set-up for preparatory works for utilities, piling and bridge extension – 12 mth+	<i>Under way</i> 28/09/2020	21/10/2021
• Ground water discharge into Harrington Street   temporary until permanent drainage in place <b>TBC</b>	26/10/2020	31/12/2020
• Hampstead Road trial hole surveys #2   in the highway and other locations inc Cartmel	<i>Under way</i> 12/10/2020	07/12/2020
• Hoarding relocated to 1m from northern end Coniston + tree removal <b>TBC</b>	23/11/2020	18/12/2020
• Hoarding realignment at the top of Harrington Street   road closed with access maintained <b>TBC</b>	16/11/2020	31/03/2021
• Hampstead Road hoarding install   northbound lane closure <b>TBC</b>	30/11/2020	18/12/2020
• Addison Lee hoarding install   footpath and lane closure <b>TBC</b>	Jan 2021 (TBC)	Jan 2021 (TBC)
• Crane lift for office cabins into site   lane, footpath closures and parking bay suspensions on Stanhope Street	11/01/2021	29/01/2021
• Utility diversion (phase 1 of 3)	05/01/2021	05/08/2021



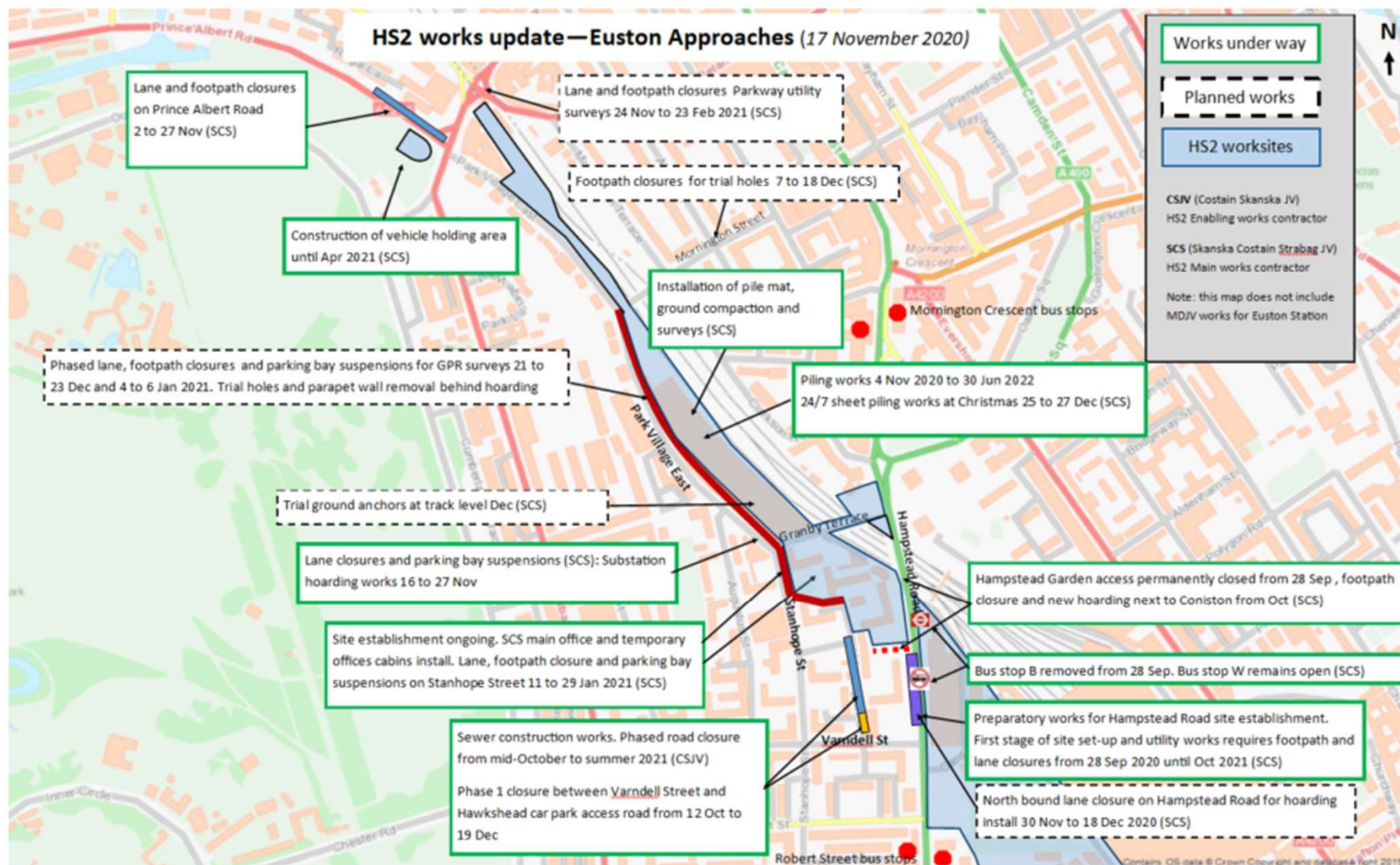

# SCS Christmas works at Euston

- 3day, 24hour Blockade of Network Rail's "Line E"
- **24<sup>th</sup> – 27<sup>th</sup> December 2020**
- Sheet piling works at track level between Mornington Street bridge and Granby Terrace bridge
- Section 61 based on all work activities running at 100% (so 'worst case')
- Quieter method using "Geken silent piler"
- Maximum predicted levels for all receptors  $L_{Aeq}$  (1hour average) 58.3dB
- Attended monitoring to date has recorded 3-5dB below predicted levels.

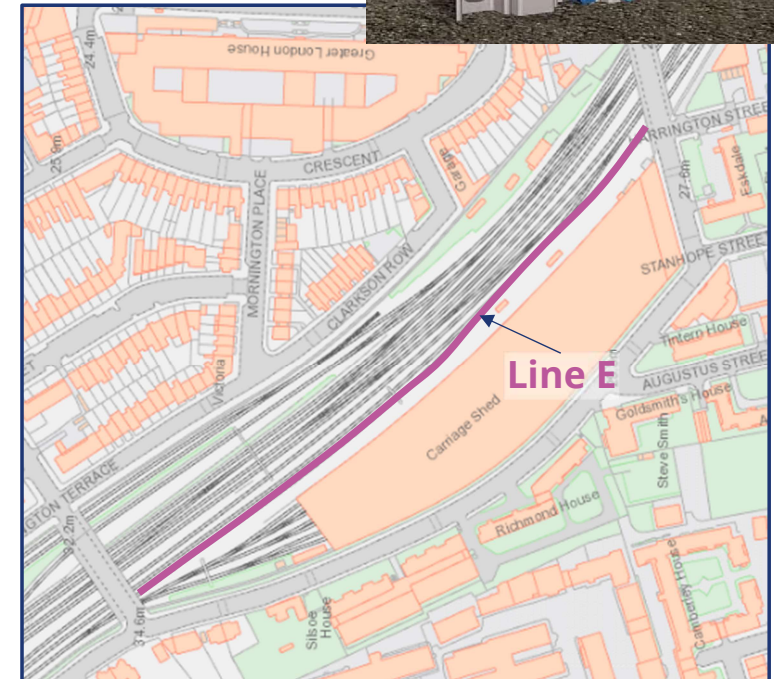
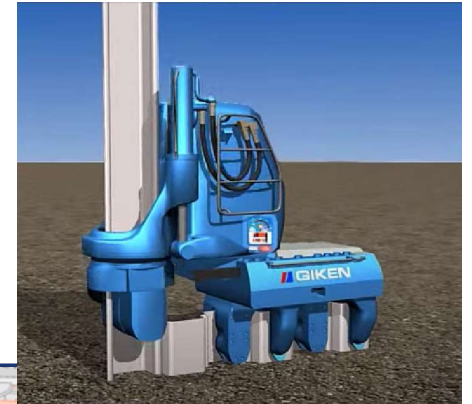



# HS2

## Network Rail ECRG Update

December 2020

# Euston track work three month look ahead

Line E work to enable high speed lines to be built



Network Rail resilience works for essential services



HS2 enabling rail track work

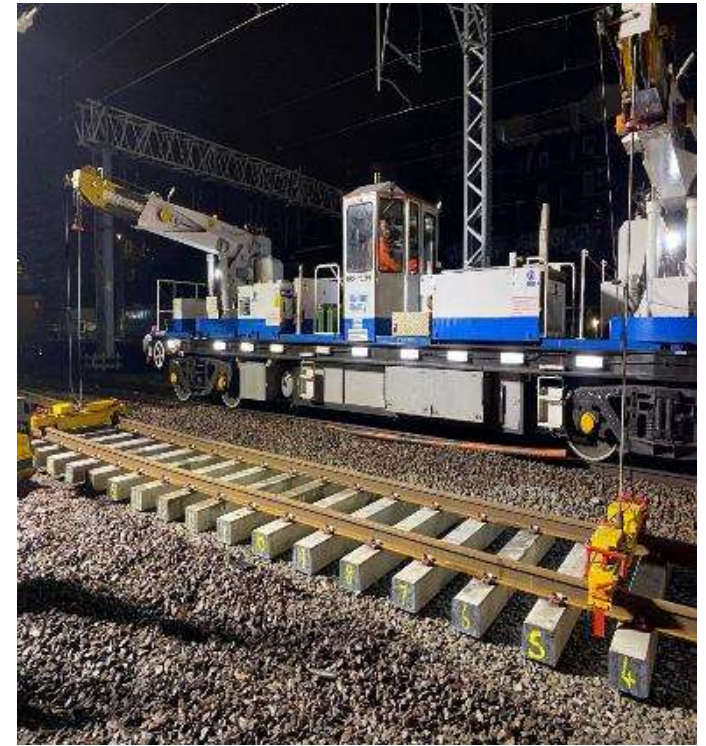



# Euston station improvement work over Christmas

Escalator to LUL upgrade work enters final phase to March 21



Removal of temporary scaffold stairs at platform 16



Work to start widening ramp to platforms 9-11



New customer information screens being installed



Deep cleaning of station to take place



Work to improve stairs to mezzanine



# HS2

## Mace Dragados ECRG Update

December 2020



# Mace Dragados Construction Partner update

**HS2 station site**  
Piling commenced  
28 Oct 2020 until  
January 2021

**Interim Taxi Rank:**  
Early works commence:  
Jan 2021 (update on homeless  
support will be provided at  
the  
ECRG Meeting)

**Traction Sub Station:**  
Early works commence: Jan  
2021

**One Euston Sq and Grant  
Thornton building  
demolitions:**  
Early Works commence:  
Dec 2020

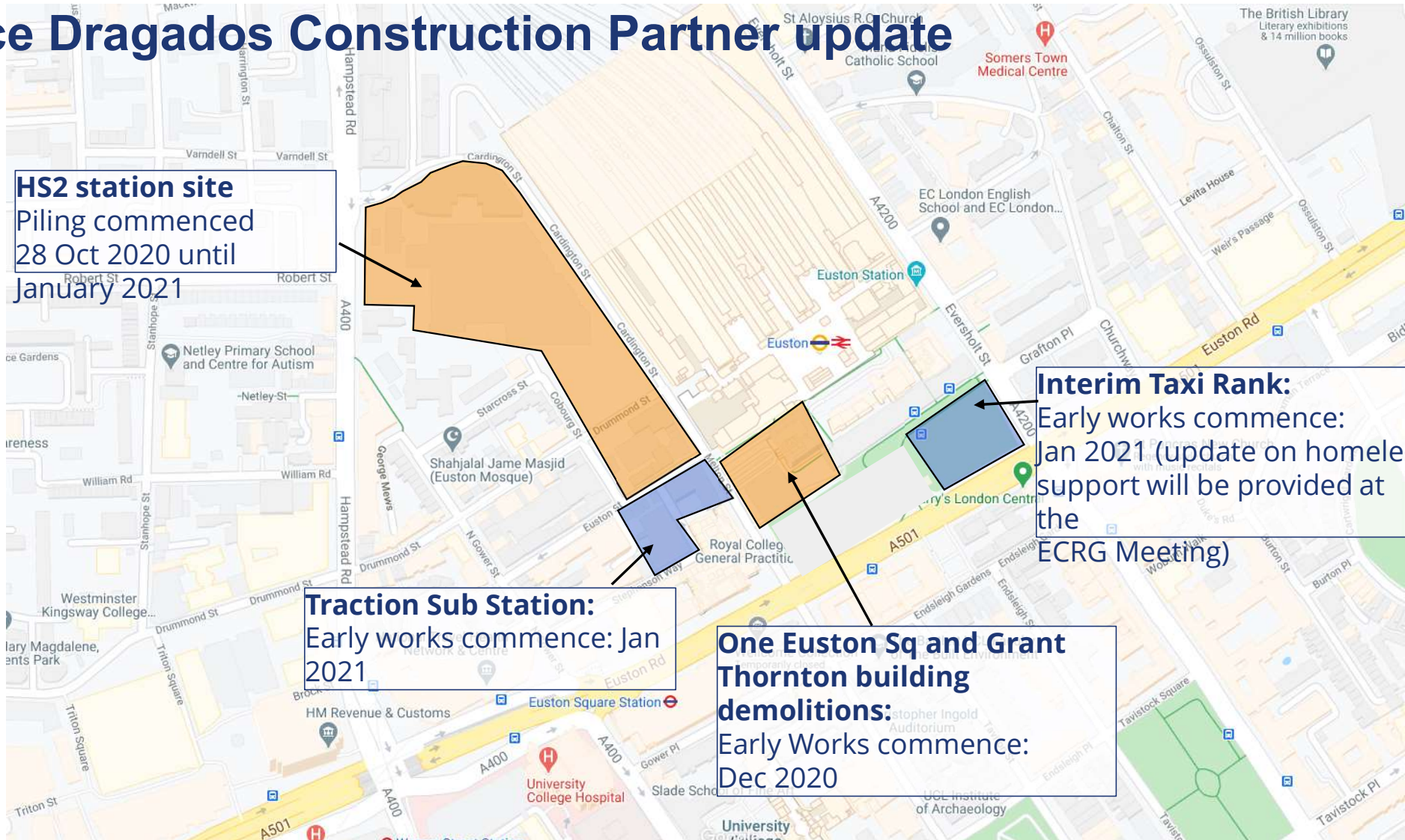



# Station hoarding



- Hoarding renewal for station project commencing in January 2021.
- Installation will start on Euston Road works and work North.
- New modular system being used (as recently installed on Cobourg Street) enhancing security.
- Reconfiguration of Drummond Street/Station link (to include arched gateway) and Royal College of General Practitioners' crossing to improve links to local businesses and flows.
- Euston wide artwork highlighting local businesses and local people.



# HS2

## CSjv ECRG Update

December 2020

# Euston west utility works

 Current utility works

 Planned works

 Two-way traffic  
direction

 One-way traffic  
direction

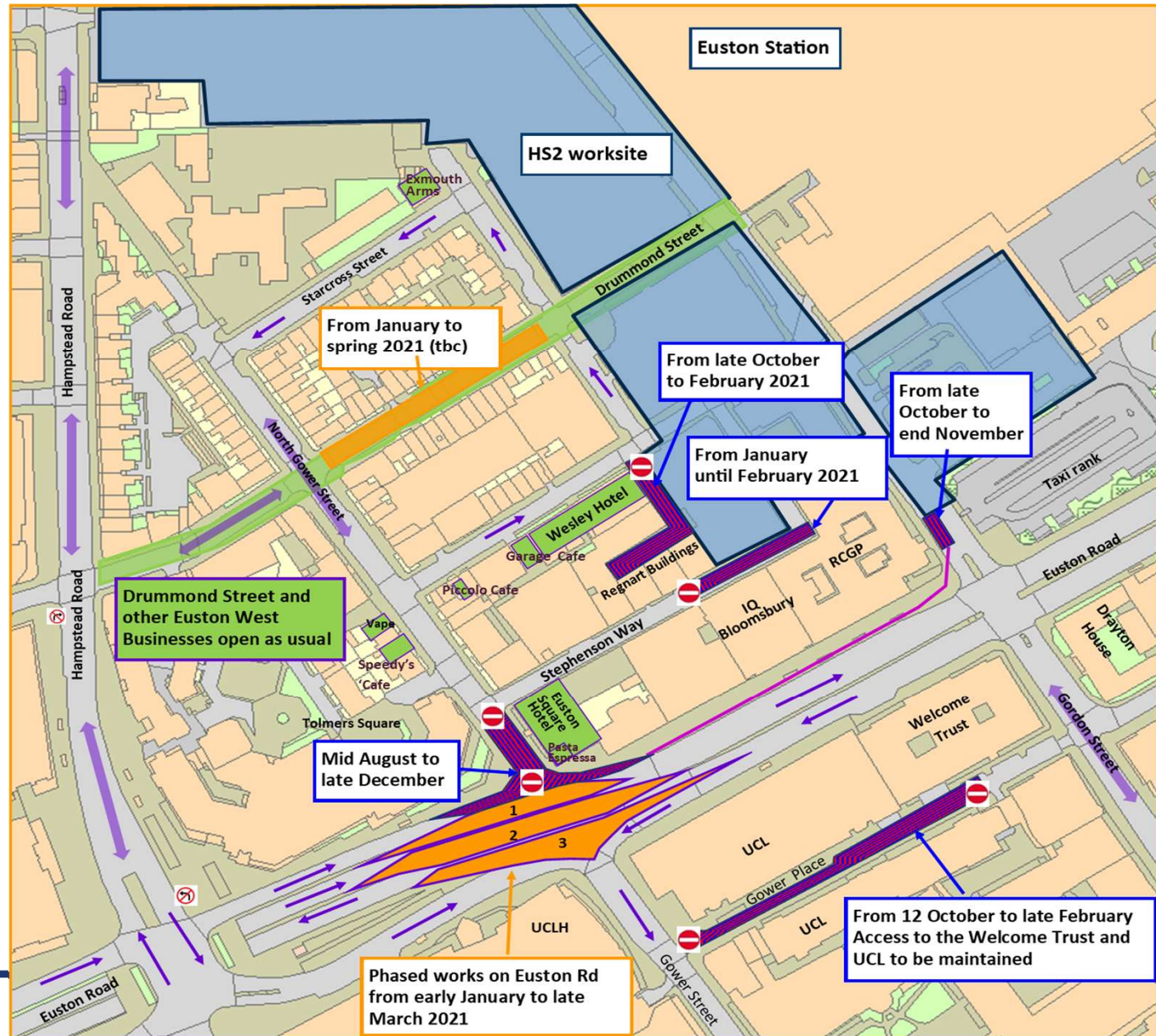



# Sewer construction works along Harrington Street

**Sewer construction in phases from 12 October 2020 to summer 2021, dates tbc**

- Phased road closures between Varndell Street and Mackworth Street
- Construction of 3m diameter manhole in the junction with Varndell Street
- Working northwards in phases
- Construction of 2.4m and 2.1m manholes and remaining pipework Harrington Street and Mackworth Street
- **Phase 1 from 12 October until 19 December. Road closed between Varndell Street and Hawkshead access road.**
- Access to Hawkshead car park will be closed, residents to be offered alternative parking spaces



# HS2

## 12 month lookahead

December 2020



# 12 month lookahead – Indicative\*

December 2020	January 2021	February 2021
<ul style="list-style-type: none"> <li>• Adelaide Rd site set up ongoing (hoarding, gates, offices, removal of wall foundations, low level veg clearance)</li> <li>• Construction of vehicle holding area (VHA) ongoing</li> <li>• Piling works in Euston Scissor Box</li> <li>• Ongoing works in Euston Scissor Box and Euston Throat Retained Cut</li> <li>• Hampstead Road utility diversion continues</li> <li>• Install new access off Hampstead Road</li> <li>• Christmas NR possession for sheet piling works in the cutting</li> <li>• Station piling</li> <li>• Fit and finishing work on Barnby St electrical substation</li> <li>• Euston station demolition and modification work along platforms 16, 17 and 18 in Euston station</li> <li>• Install of 11kv cable route ongoing</li> </ul>	<ul style="list-style-type: none"> <li>• Adelaide Road tree removal within site boundary</li> <li>• Adelaide Road set up for sheet piling works commences</li> <li>• Piling continues for westside retaining wall in Euston Throat Retained Cut (Granby Terrace end)</li> <li>• Granby Terrace Bridge site offices installation starts</li> <li>• Hampstead Road utility diversion continues</li> <li>• Piling works in Euston Scissor Box</li> <li>• Construction of taxi rank – early works (East Gardens)</li> <li>• Station piling</li> <li>• Traction Sub Station early works</li> <li>• One Euston Square (ES) and Grant Thornton (GT) demolitions – early works</li> </ul>	<ul style="list-style-type: none"> <li>• Adelaide Road set up for sheet piling works continues</li> <li>• Piling for westside retaining wall in Euston Throat Retained Cut continues towards Hampstead Road bridge</li> <li>• Piling at Granby Terrace Bridge</li> <li>• Granby Terrace southern abutment works and span demolition</li> <li>• Ground anchors start</li> <li>• Hampstead Road utility diversion continues</li> <li>• Piling works in Euston Scissor Box</li> <li>• Construction of taxi rank – early works (East Gardens)</li> <li>• Completion of piling for station box</li> <li>• TSS early works</li> <li>• Ground Investigations – Euston Road</li> <li>• One ES and GT demolitions – early works</li> </ul>

*\* Dates may change following impacts of COVID-19 on the programme and activities may need to be realigned. We will keep stakeholders informed in a timely manner*

# 12 month lookahead – Indicative\*

March 2021	April 2021	May 2021
<ul style="list-style-type: none"> <li>• Adelaide Road set up for sheet piling works continues</li> <li>• Piling for westside retaining wall in Euston Throat Retained Cut continues towards Hampstead Road bridge</li> <li>• Granby Terrace southern abutment works and span demolition continues</li> <li>• Ground anchors continue</li> <li>• Hampstead Road utility diversion continues</li> <li>• Piling works in Euston Scissor Box</li> <li>• Construction of taxi rank – early works (East Gardens)</li> <li>• Traction Sub Station (TSS) early works</li> <li>• Ground Investigations – Doric Way / Euston Road</li> <li>• One Euston Square (ES) and Grant Thornton (GT) demolitions – main works</li> </ul>	<ul style="list-style-type: none"> <li>• Adelaide Road site offices/ welfare set up commences</li> <li>• Adelaide Road sheet piling, ground anchors and excavation package starts</li> <li>• Piling for westside retaining wall in Euston Throat Retained Cut continues towards Hampstead Road bridge</li> <li>• Granby Terrace southern abutment works and span demolition</li> <li>• Ground anchors continue</li> <li>• Boreholes along Park Village East (southern end) start</li> <li>• Hampstead Road utility diversion continues</li> <li>• Piling works in Euston Scissor Box</li> <li>• NR possession (6 weeks, nightworks)</li> <li>• Construction of taxi rank – main works (East Gardens)</li> <li>• TSS main works</li> <li>• Ground Investigations – Doric Way</li> <li>• One ES and GT demolitions – main works</li> </ul>	<ul style="list-style-type: none"> <li>• Adelaide Road site offices/ welfare set up continues</li> <li>• Adelaide Road sheet piling, ground anchors and excavation package ongoing</li> <li>• Vehicle holding area operational</li> <li>• Piling for westside retaining wall in Euston Throat Retained Cut continues towards Hampstead Road bridge</li> <li>• Granby Terrace southern abutment works and span demolition</li> <li>• Ground anchors continue</li> <li>• Boreholes along Park Village East (southern end) continue</li> <li>• Hampstead Road utility diversion continues</li> <li>• Piling works in Euston Scissor Box</li> <li>• Construction of taxi rank – main works (East Gardens)</li> <li>• TSS main works</li> <li>• One ES and GT demolitions – main works</li> </ul>

\* Dates may change following impacts of COVID-19 on the programme and activities may need to be realigned. We will keep stakeholders informed in a timely manner

# 12 month lookahead – Indicative\*

## June 2021

- Adelaide Road sheet piling, ground anchors and excavation package ongoing
- Piling works for Euston cavern and shaft start
- Piling for Euston Throat Retained Cut and Scissor Box continues
- Granby Terrace s abutment works / span demolition
- Ground anchors continue
- Hampstead Road utility diversion continues
- Boreholes along Park Village East
- Construction of taxi rank, main works (East Gardens)
- Traction Sub Station(TSS) main works

## July 2021

- Adelaide Road sheet piling and earthworks ongoing
- Adelaide Road and surrounds utility diversions
- Ground anchors continue
- Earthworks to Park Village East wall, and boreholes
- Park Village East (northern end) street level hoarding and site welfare for lorry layby
- Piling for Euston Scissor Box & Throat continue
- Hampstead Road utility diversion continues
- Parkway Utility works start
- Construction of taxi rank main works (East Gardens)

## August 2021

- Adelaide Road sheet piling and earthworks ongoing
- Adelaide Road and surrounds utility diversions
- Earthworks to Park Village East wall
- Piling for Hampstead Road bridge (next to Cartmel - tbc)
- Piling for Euston Scissor Box & Throat continue
- Parkway Utility Works continue
- TSS main works
- Construction of taxi rank – main works (East Gardens)
- TSS main works
- One ES and GT demolitions – main works

## September 2021

- Adelaide Road sheet piling and earthworks ongoing
- Adelaide Road and surrounds utility diversions
- Set-up for piling at Hampstead Rd Bridge South abutment
- Site set-up at old garage at Hampstead Road
- New utility route works start Granby Terrace / Stanhope Street, Oakley Sq/Eversholt St
- Piling for Euston Scissor Box & Throat continue
- Parkway Utility Works continue
- Construction of taxi rank, main works (East Gardens)
- TSS main works

## October 2021

- Adelaide Road sheet piling and earthworks ongoing
- Adelaide Road and surrounds utility diversions
- Piling at Hampstead Rd Bridge
- New utility routes Granby Terrace / Stanhope Street, Oakley Sq/Eversholt St
- Piling for Euston Scissor Box & Throat continue
- Parkway Utility Works continue
- Construction of taxi rank, main works (East Gardens)
- TSS main works

## November 2021

- Adelaide Road sheet piling and earthworks ongoing
- Adelaide Road and surrounds utility diversions
- Piling at Hampstead Rd Bridge
- New utility routes Granby Terrace / Stanhope Street, Oakley Sq/Eversholt St
- Piling for Euston Scissor Box & Throat continue
- Parkway Utility Works continue
- Construction of taxi rank, main works (East Gardens)
- TSS main works

\* Dates may change following impacts of COVID-19 on the programme and activities may need to be realigned. We will keep stakeholders informed in a timely manner

# HS2

## SRO Studies

**[to be updated at the meeting]**

# HS2

## Noise Insulation



# Noise Insulation

Stage	Number
Total number of properties in scheme	1409
'Live' properties (resident engaged)	841*
Surveys completed	619
Secondary glazing installed	431
Mechanical ventilation installed	102

\*240 of these properties are Amptill high rise units which are subject to a bespoke design.

Programme Update
<ul style="list-style-type: none"> <li><b>Cubitt Court and Tintern House</b> have recently triggered and all noise insulation works for which we were given access have been completed in these locations.</li> <li><b>New subcontractor (Adept)</b> installing mechanical ventilation in all <i>non</i>-listed properties with 85 properties closed out since the beginning of September, and a current focus on Cartmel, Coniston and Langdale.</li> <li><b>New subcontractor (Selectaglaze)</b> started on site 25-Nov-20 replacing Everest who went into administration during the first COVID-19 lockdown.</li> <li><b>Some delays</b> finalising the contract with the new subcontractor that will install mechanical ventilation in listed buildings. Plans to have them in contract by mid-December.</li> <li><b>Amptill high rise design</b> almost complete pending information to be provided by Camden.</li> </ul>

Trigger Dates		
Location	Trigger Date	Status
Cubitt Court	04-Nov-20	Achieved
Tintern House	04-Nov-20	Achieved
Cobourg Street, Drummond Street, Starcross Street	2021 TBC	On track
Cartmel, Coniston, Langdale, Mornington Terrace, Richmond House, Augustus House, Goldsmith House, Silsoe House, Mornington Place, Clarkson Row, Ambleside, Mornington Crescent, Park Village East	03-Apr-21	On track

Secondary glazing has been installed in 72% of the properties where residents are responsive (excluding Amptill high rise).

We are working hard to reduce the mechanical ventilation backlog

Our uptake rate is around 60%

# Noise insulation Dashboards

	Euston-Wide			Camden-Owned		
	Total	% of Live	% of Eligible	Total	% of Live	% of total
<b>Total Figures</b>						
Eligible	1408		100%	799		57%
Concluded	567		40%	271		48%
Live*	841		60%	528		63%

	Total	% of Live	% of Eligible	Total	% of Live	% of Eligible
<b>Noise Insulation Status</b>		<b>Live Properties (Euston-Wide)</b>		<b>Live Properties (Camden-Owned)</b>		
Awaiting Survey**	222	26%	16%	36	7%	5%
Total surveys complete	619	74%	44%	478	91%	60%
Awaiting offer acceptance	90	11%	6%	44	8%	6%
Total offers accepted	547	65%	39%	51	10%	6%
Awaiting Sonair install	329	39%	23%	462	88%	58%
Glazing install complete	431	51%	31%	230	44%	29%

	Total	% of Live	% of Eligible
<b>Noise Insulation Status - Heritage</b>			
Eligible	281	33%	100%
Concluded	119	21%	42%
Live	162	19%	58%

	Total	% of Live	% of Eligible
<b>Noise Insulation Status - Heritage</b>			
Awaiting Survey***	105	65%	37%
Total surveys complete	57	35%	20%
Awaiting offer acceptance	39	24%	14%
Total offers accepted	94	58%	33%
Awaiting Sonair installation	72	44%	26%
Installations complete	32	20%	11%

## Cartmel

Cartmel - Overall		
Eligible	69	
Concluded	20	29%
Live	49	71%
Glazed	42	86%
Ventilated	7	14%

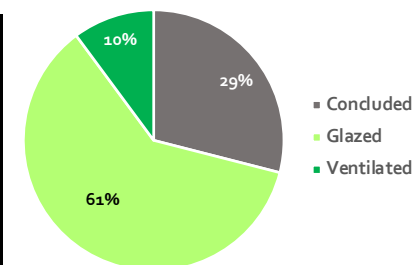

Cartmel - Ventilation		
Live 'to go'	42	86%
Unresponsive	18	43%
Resident hold	11	26%
Survey complete	3	7%
Survey booked	6	14%

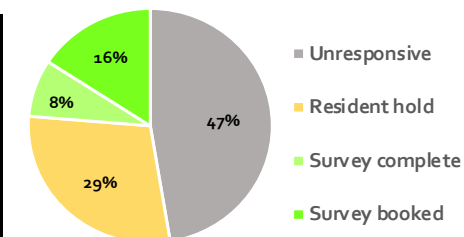

Cartmel - Glazing		
Live 'to go'	7	17%
Manufactured	3	43%
Awaiting acceptance	1	14%
Offer to be made	3	43%

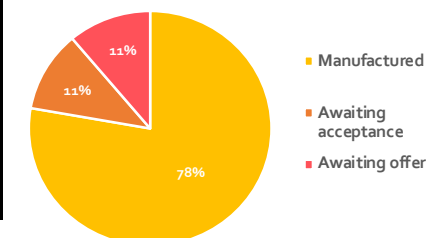

# Noise insulation Dashboards

## Coniston

Coniston - Overall		
Eligible	24	
Concluded	2	8%
Live	22	92%
Glazed	16	73%
Ventilated	4	18%

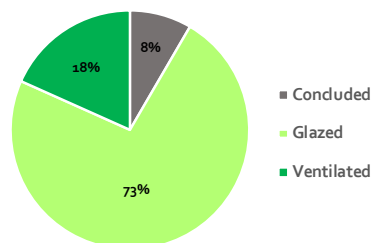

Coniston - Ventilation		
Live 'to go'	18	82%
Unresponsive	11	61%
Resident hold	4	22%
Install booked	1	6%
Survey complete	1	6%
Survey booked	1	6%

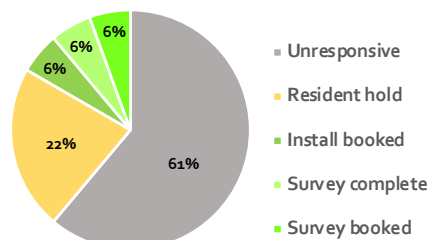

Coniston - Glazing		
Live 'to go'	7	32%
Manufactured	3	43%
Awaiting acceptance	3	43%
Offer to be made	1	14%

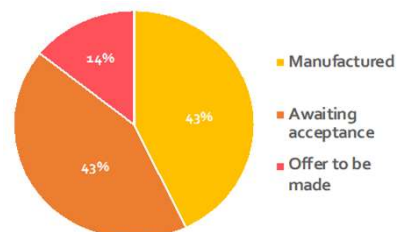

## Langdale

Langdale - Overall		
Eligible	61	
Concluded	17	28%
Live	44	72%
Glazed	32	73%
Ventilated	2	5%

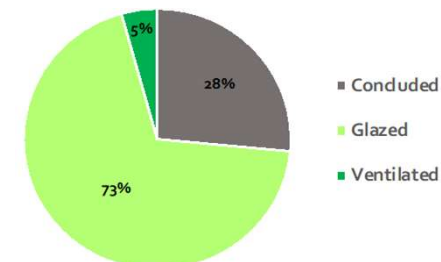

Langdale - Ventilation		
Live 'to go'	42	95%
Unresponsive	18	43%
Resident hold	3	7%
In progress	12	29%
Install booked	2	5%
Survey complete	5	12%
Survey booked	2	5%

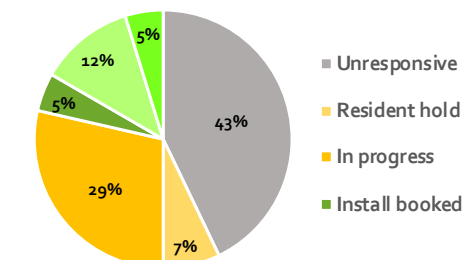

Langdale - Glazing		
Live 'to go'	11	25%
Manufactured	5	45%
Awaiting acceptance	3	27%
Offer to be made	3	27%

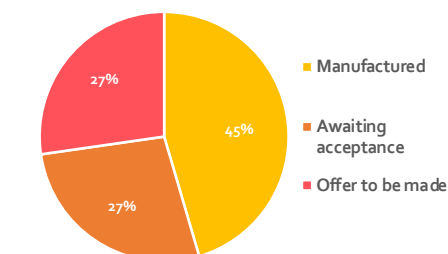

# HS2

## Adelaide Road Vent Shaft Site

# Proposals at Hybrid Bill stage

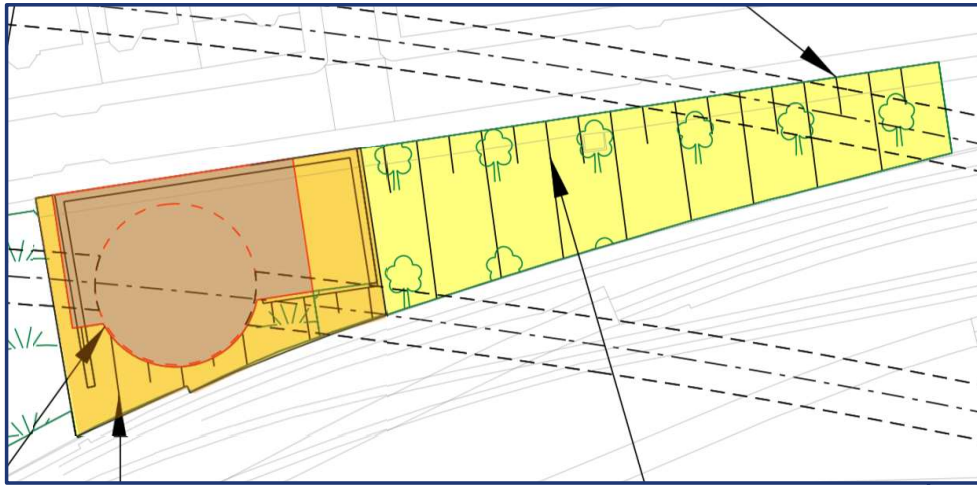

Extract from "Adelaide Road Environmental Mitigation Plan" (included in "Exhibit M" during Parliamentary process, and as per Environment Statement Map books), shows

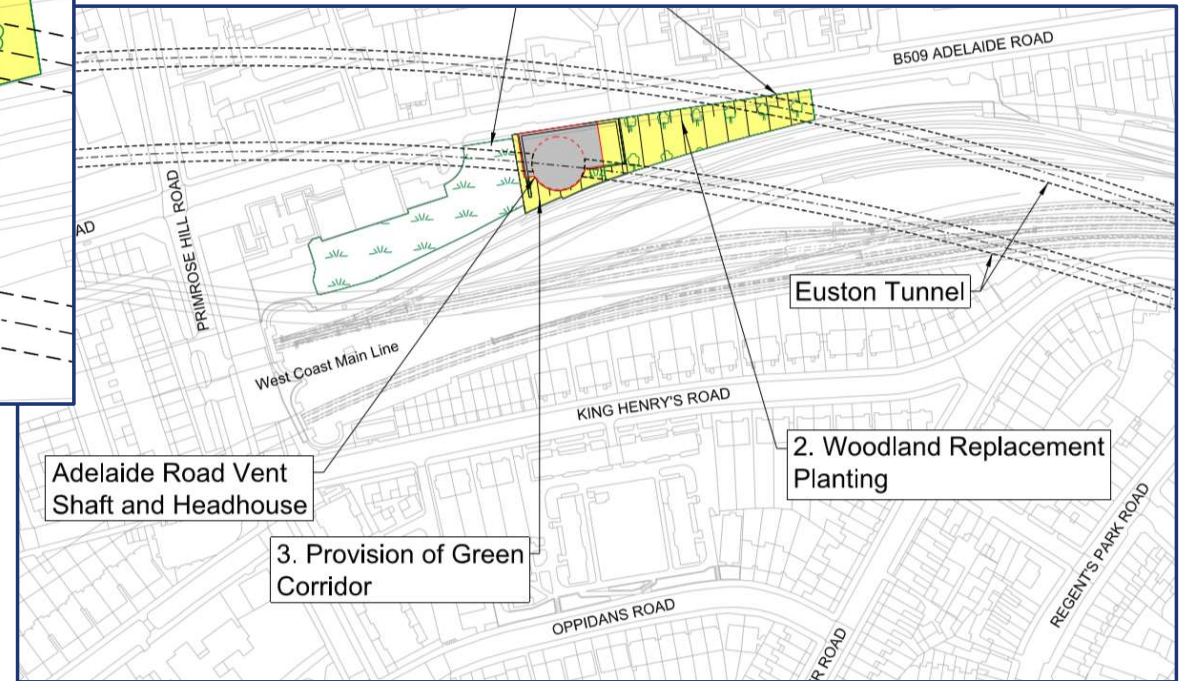

- Proposed Adelaide Road head house compound – approximately 0.33 hectares
- Indicative extent of area to be replanted – approximately 0.2 hectares

# Design developments

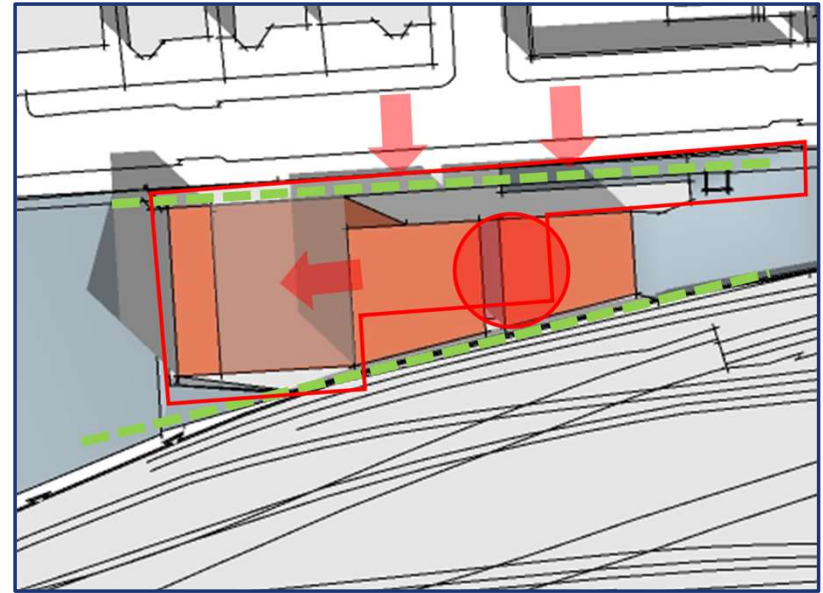
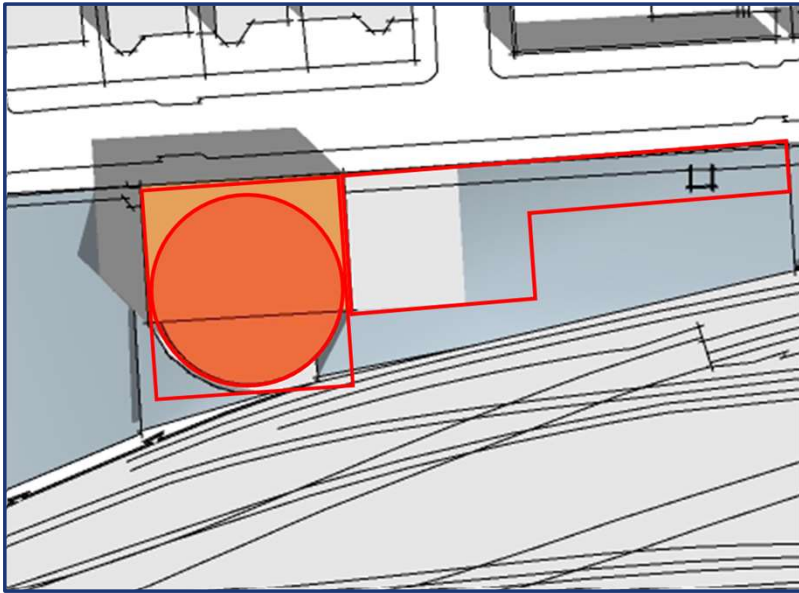

During the first phase of scheme design in late 2017, the headhouse configuration was reviewed and horizontal fans within the headhouse, instead of vertically aligned fans were introduced. The shaft is smaller, reducing the amount of excavation and the associated lorry movements.

The structure could then be repositioned within the permanent compound. This allows a continuous boundary wall, instead of the building being part of the boundary, giving a less industrial feel, and also enabling a planting area to both the road side and rails side frontages



# Scheme design to date

- The early scheme design (or outline design) for the head house structure was shared at the initial design engagement in summer 2018.
- Detailed design is now underway
- Additional engagement events will be held on the proposed building design, to include the boundary on Adelaide Road



Indicative view from Adelaide Road



Indicative view from existing railway

*Indicative landscaping and wall finishes only*



# Proposed landscape layout at scheme design

Indicative design shared in 2018, showing the 'graded' landscape plan, from ballast and grasses at trackside, to scrub / shrub planting and through to woodland, to encourage biodiversity.

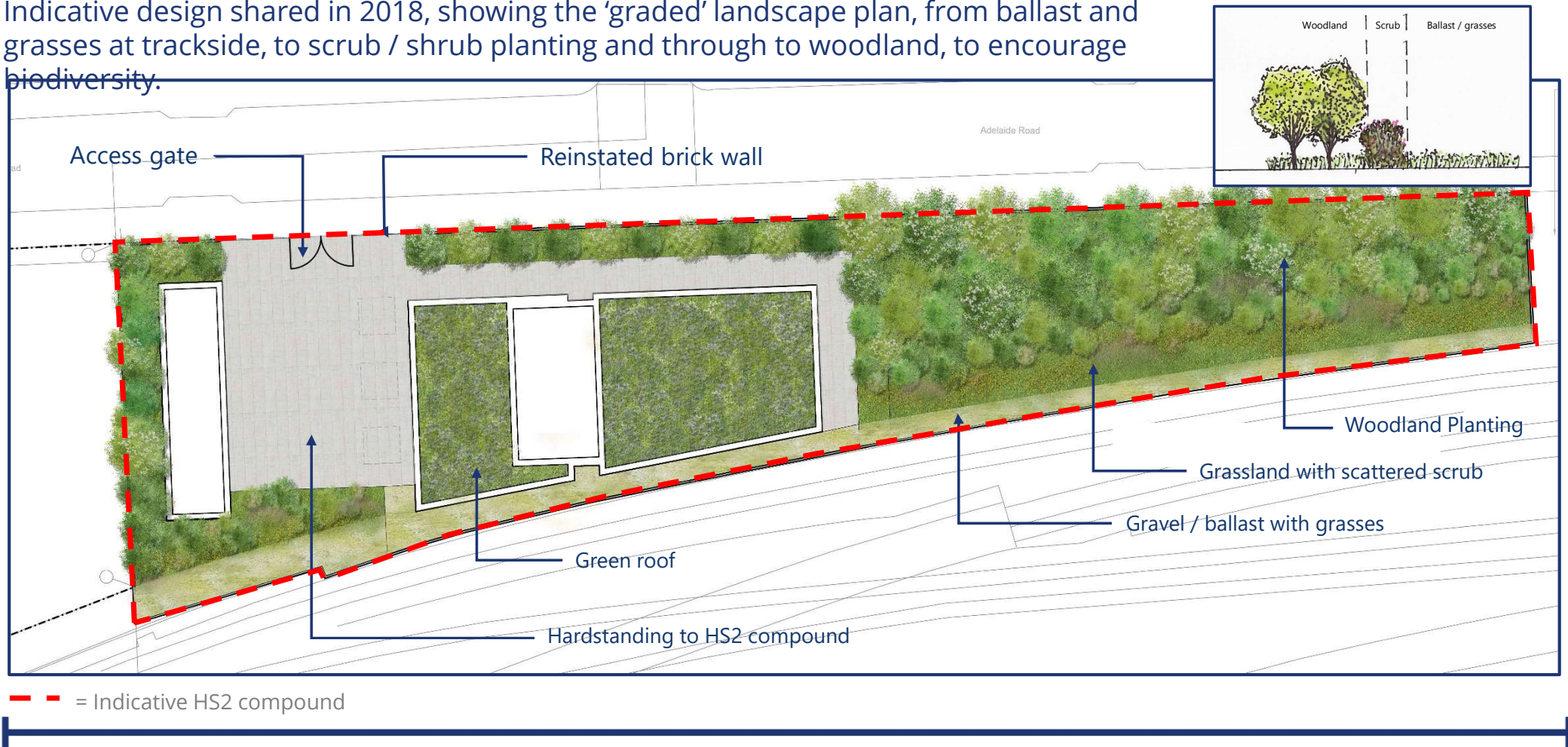

# Proposed landscape layout at scheme design

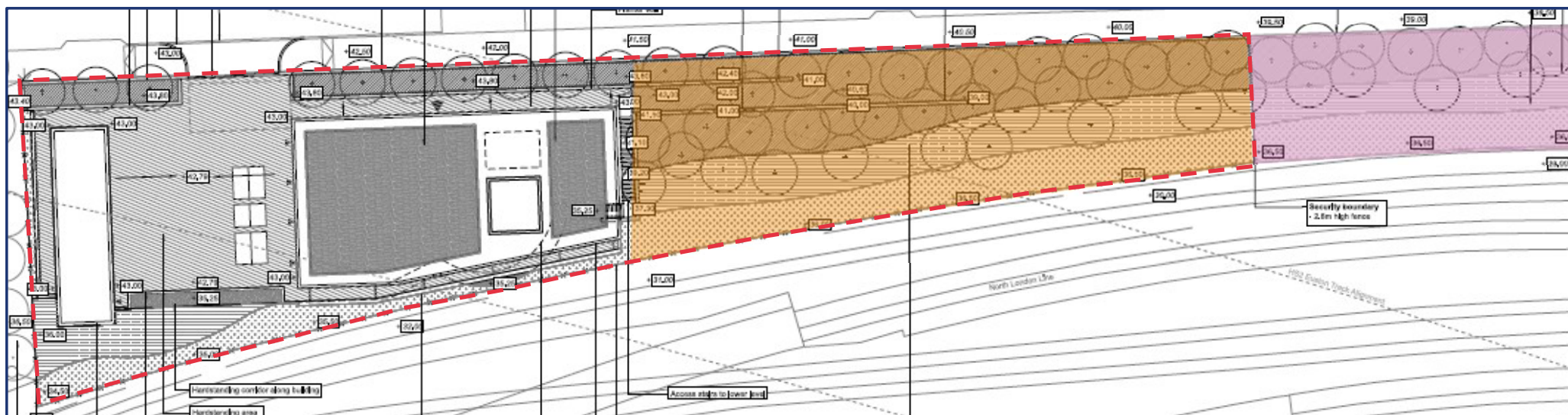

This extract shows the work in progress (up to Nov'19) on the landscape plan, using the graded landscape principle (as before).

The main area of planting (shaded in orange, approx. 0.12 hectares\*) within the overall headhouse compound will be maintained within the permanent site boundary (dotted red line) of approximately 0.31 hectares\*. Overall mitigation area, including soft landscaping within the grey compound area is currently at approx. 0.155 hectares\*

The area shaded pink (and any additional temporary land take) will be returned to the landowner, Network Rail, and will also be replanted as part of the site restoration scheme.

--- = Indicative HS2 compound

\* Areas are still indicative and will be confirmed during detailed design



# Current construction compound

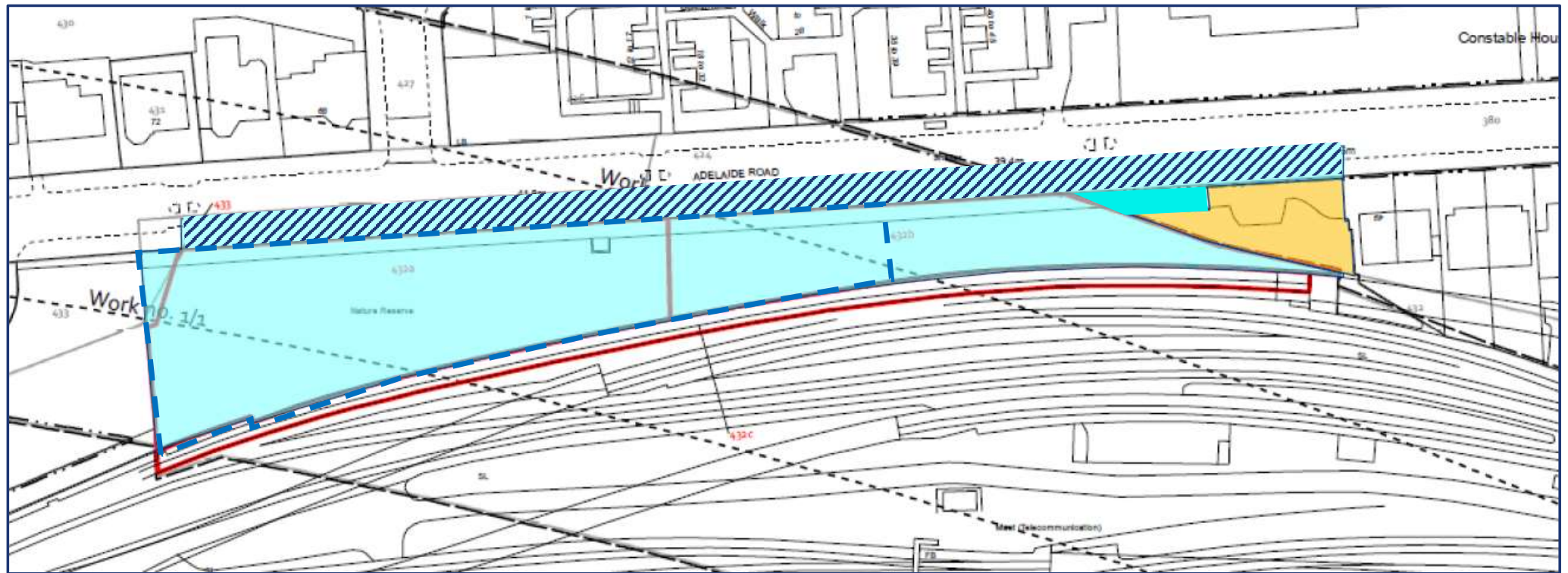

- |   |   |
|---|---|
|  Existing construction compound (approx. 0.46ha)  |  Public footway / highway in use under Schedule 16           |
|  Additional area acquired direct from Network Rail in mid-2020 for access to new access ramp for HGVs |  Network Rail land   |
|   |  Indicative permanent boundary (approximate, from Exhibit M) |

# SCS site layout for construction

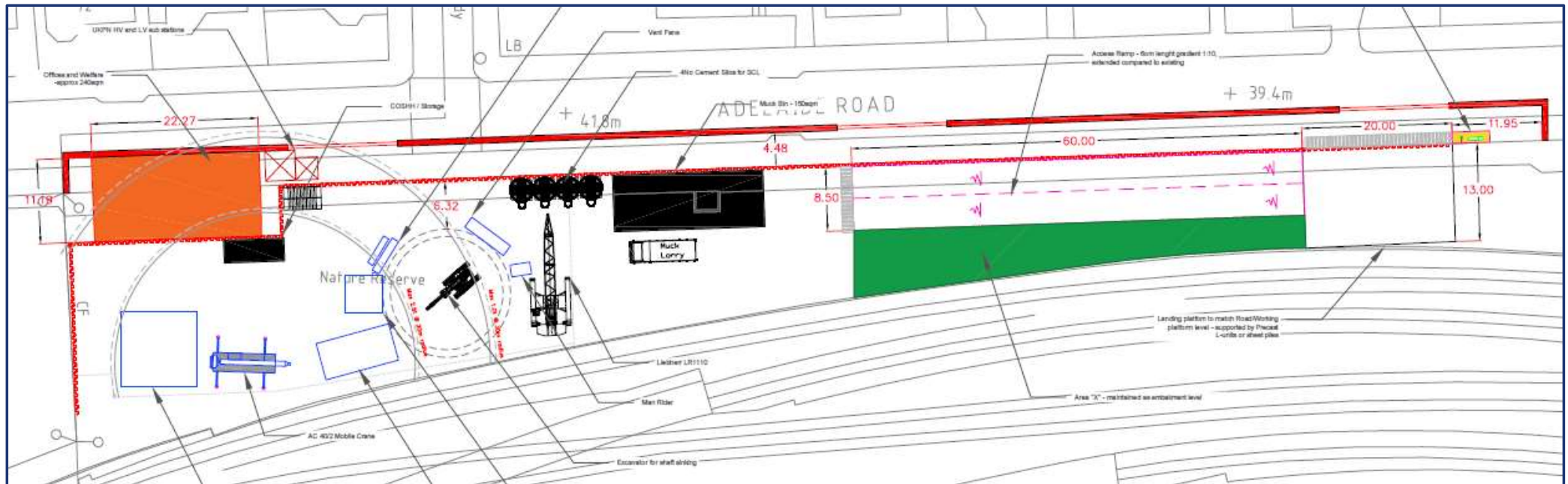

- This shows the proposed construction site layout, as discussed at September 2020 ECRG
- Full clearance of the site will be required, due to very limited space available.
- An access ramp will be constructed to enable lorries to access the full site, due to the steep embankment
- There will be no stockpiling of felled timber on site.
- Very limited stockpiling of excavated material will take place on the site, material will be removed as early as possible after excavation

# Planning Approvals required for Adelaide

## Schedule 17 Plans & Specifications

Seeks approval for permanent buildings, such as the head house, boundary fences, walls, lighting etc

Submission estimate  
**Late 2021/ early**

**2022\***

## Schedule 17 Bringing into Use

Seeks approval for mitigation schemes prior to bringing into use of any scheduled above-ground work, such as the head house

Submission estimate  
**2025\***

## Schedule 17 Site Restoration

Construction sites must be restored in accordance with a scheme submitted to the local planning authority within four months of the end of works at the site

Submission estimate  
**2025/26\***

*\* These are indicative dates and currently under review, so are subject to change depending in design progress*