



Notice of work A413 and Bottom House Farm Lane

May 2020 | www.hs2.org.uk

High Speed Two (HS2) is the new high speed railway for Britain. We are continually reviewing the works on our construction sites in line with Government and Public Health England (PHE) advice on dealing with COVID-19. The Government's current strategy makes it clear that construction activity can continue as long as it complies with this guidance.

Please be assured that only sites that can operate within the guidelines are operational. All sites will remain under constant review. We have postponed all face-to-face engagement events and meetings and have put in place a number of channels to communicate with communities, such as letters and phone calls, as well as updates and alerts from each of the local community websites. You can sign up for regular updates in your local area at www.hs2inbucksandox.co.uk

Bottom House Farm Lane in Chalfont St Giles will be the site of one of the Chiltern Tunnel's ventilation shafts, which will be located about a mile from its junction with the A413. To access the site safely a new temporary access road must be built as the lane is too narrow for Heavy Good Vehicles (HGVs) to use. As you will know, works have been ongoing on the lane over the last few months to prepare for the road construction. This includes our welfare, site establishment and preparation works. Our community notice in April described this work. This notification can be found at www.hs2inbucksandox.co.uk under the 'in your area' section. If you would like a hard copy of the previous notification re-posted to you please contact our helpdesk on 08081 434 434.

This notice is providing an update on the works, particularly the works that we need to undertake on the A413 at the junction with Bottom House Farm Lane.

If you have a question about HS2 or our works, please contact our HS2 Helpdesk team on 08081 434 434 or email hs2enquiries@hs2.org.uk

Duration of works

Late May 2020 until August 2020

Monday to Friday 8am – 6pm and Saturday 8am – 1pm

We may also be on site for one hour's quiet start up and shutdown outside of these times

What to expect

Access road construction

Junction construction

Utility surveys and diversions

Vehicle movements along the lane

Speed restriction on A413

A413 lane closures

A413 night time closure

What we will do

Respond promptly to any queries or complaints and take appropriate action

Clean the lane regularly to minimise mud on the road surface as much as possible and control dust

Notice of work A413 and Bottom House Farm Lane

Notification



www.hs2.org.uk

Junction of Bottom House Farm Lane and A413

A new signalised junction is to be created with the A413 to replace the existing Bottom House Farm Lane junction during the construction of the vent shaft. The junction construction needs traffic management on the A413 and Bottom House Farm Lane. This will involve different phases.

Phase one works – June 2020 for 4 weeks

The Amersham bound lane of the A413 will be closed and the A413 reduced to a single lane under 24 hour traffic light operation. The closed lane is required to create a safe working area to start the construction of the new junction bell mouth in the existing verge. During this time the existing Bottom House Farm Lane access will remain open for public and HS2 traffic with three way traffic lights installed to provide safe controlled access onto the A413.

This first phase of works is required for 4 weeks during June 2020.

Works will be done during the day where possible to reduce night time disturbance in the area and in response to current reduced traffic flow. Advanced warning signage to A413 motorists will be provided.

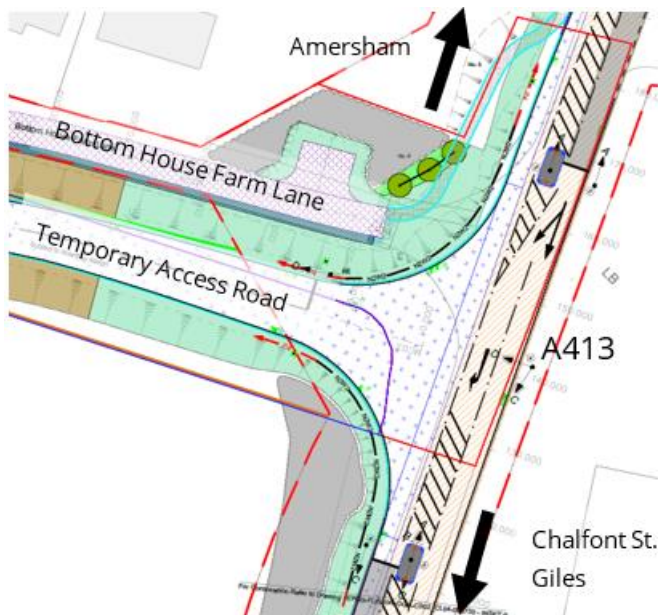

Contact our HS2 Helpdesk team on [08081 434 434](tel:08081434434)

Notice of work A413 and Bottom House Farm Lane

Notification



www.hs2.org.uk

Phase two works – One night A413 road closure, expected at end of June 2020 : 9 pm to 5am

Anticipated at the end of June, following completion of the phase one works, a one-night duration closure of the A413 is required to install a temporary safety barrier on the A413 alongside the new junction bell mouth. This closure will be undertaken at night to reduce A413 disruption. Following the installation of this barrier the A413 will be fully re-opened, with the A413 operating in both directions.

Advanced warning signage will be installed prior to this closure and a signed diversion route put in place. Details of this diversion are shown later in this notice. Residents and businesses within the closed off section of the A413 will be able to access their properties during this time from each end of the closure. We have kept the emergency services informed of these works and during the closure emergency service access will be provided at all times along the A413.

Phase three works – A413 / Bottom House Farm Lane junction temporary 24 hour traffic lights

To provide safe access for public and HS2 construction traffic to join the A413 from the existing lane temporary traffic lights will be installed during the phase two night closure. These three way traffic lights will be in operation 24 hours per day to provide vehicles with safe access onto the A413. These lights are required outside of the construction working hours as visibility onto the A413 will be impaired by the neighbouring temporary safety barrier. The expected duration of this third phase of works is from the end of June to the end of July 2020.

Phase four works – Completion of the junction and diversion of Bottom House Farm Lane

The subsequent works to complete construction of the junction and maintain Bottom House Farm Lane access onto the A413 via the new road will follow in late July.

We will write to you again ahead of further works to this junction and how we will maintain public highway access and minimise disruption on the A413. It is anticipated that we will require reintroduction of single lane A413 traffic lights and at times overnight closures to construct the traffic islands in the A413.

Notice of work A413 and Bottom House Farm Lane

Notification



www.hs2.org.uk

A413 Speed Restriction

A 40mph speed limit will be introduced on a 640m section of the A413 around the Bottom House Farm Lane junction. The speed restriction comes into effect from 1st June 2020 and will remain for the period that the access road is in place.

This is required for safe operation of the new junction, in particular for vehicles entering and exiting Bottom House Farm Lane.



Contact our HS2 Helpdesk team on [08081 434 434](tel:08081434434)

Notice of work A413 and Bottom House Farm Lane

Notification



www.hs2.org.uk

Bottom House Farm Lane road closure

The Western end of Bottom House Farm Lane, near to the vent shaft is to be closed to widen the road and create the access into the vent shaft site. The new temporary access road overlaps with the existing lane in this area therefore the closure is needed to remove the old road and to build the new one. This closure will be for a period of three months from early June to the end of August. This closure also includes pedestrian through access.



Contact our HS2 Helpdesk team on [08081 434 434](tel:08081434434)

Notice of work A413 and Bottom House Farm Lane

Notification



www.hs2.org.uk

Diversion routes

During the Phase Two single night closure of the A413, signposted diversion routes will be in place between 9pm and 5am. The below map details the diversion routes. Cokes Lane will be accessible for smaller vehicles with an additional signposted diversion suitable for HGVs via the A404 and B4442.



For the section of existing single carriageway on Bottom House Farm Lane that is to be closed near the vent shaft site, a signposted diversion will be in place as per the below map.

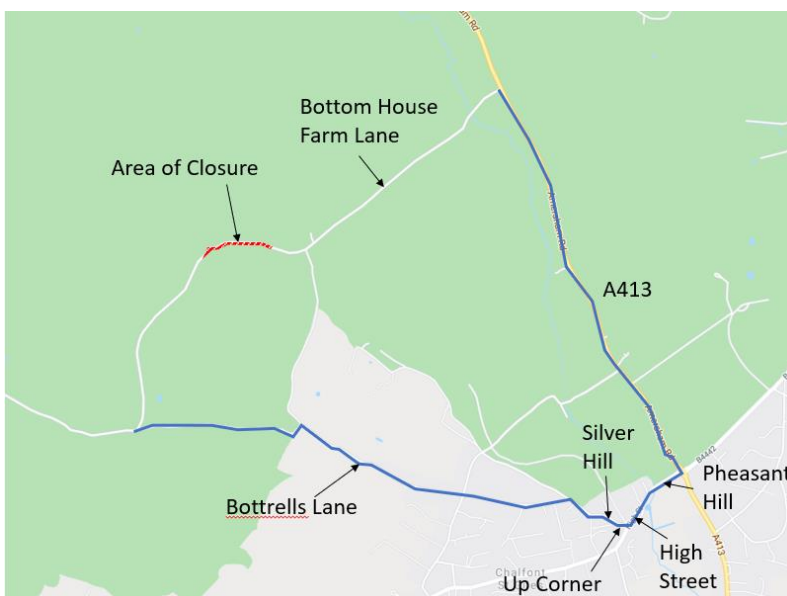

Contact our HS2 Helpdesk team on **08081 434 434**

Notice of work A413 and Bottom House Farm Lane

Notification



www.hs2.org.uk

Public Rights of Way

Public rights of way will remain open throughout construction. A safe passage will be maintained through the worksite for the public rights of way that cross Bottom House Farm Lane shown below. During the Bottom House Farm Lane road closure there will be no through route for pedestrian access. Signage will be erected informing pedestrians.

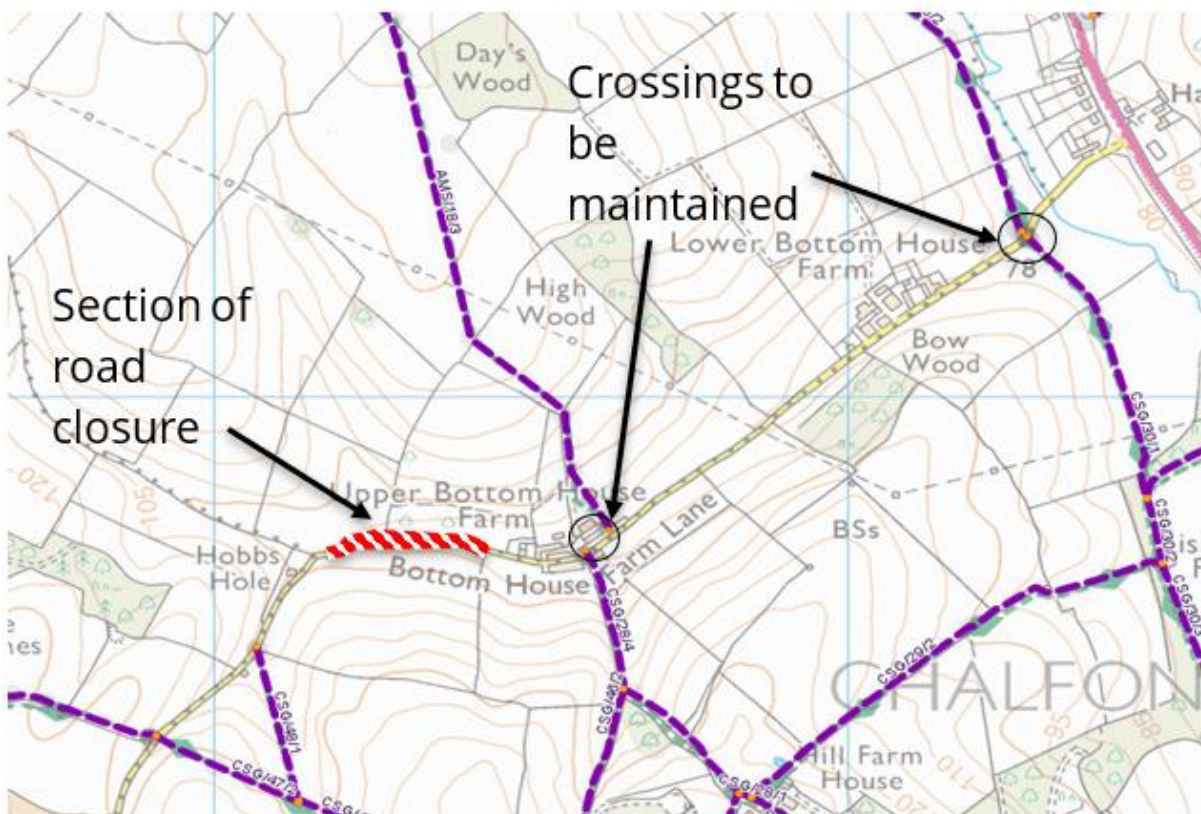

Contact our HS2 Helpdesk team on [08081 434 434](tel:08081434434)

Keeping you informed

We are committed to keeping you informed about work on HS2. This includes ensuring you know what to expect and when to expect it, as well as how we can help.

Residents' Charter and Commissioner

The Residents' Charter is our promise to communicate as clearly as we possibly can with people who live along or near the HS2 route. www.gov.uk/government/publications/hs2-residents-charter

We also have an independent Residents' Commissioner whose job is to make sure we keep to the promises we make in the Charter and to keep it under constant review. Find reports at: www.gov.uk/government/collections/hs2-ltd-residents-commissioner

You can contact the Commissioner at: residentscommissioner@hs2.org.uk

Construction Commissioner

The Construction Commissioner's role is to mediate and monitor the way in which HS2 Ltd manages and responds to construction complaints. You can contact the Construction Commissioner by emailing: complaints@hs2-cc.org.uk

Property and compensation

You can find out all about HS2 and properties along the line of route by visiting: www.gov.uk/government/collections/hs2-property
Find out if you're eligible for compensation at: www.gov.uk/claim-compensation-if-affected-by-hs2

Holding us to account

If you are unhappy for any reason you can make a complaint by contacting our HS2 Helpdesk team. For more details on our complaints process, please visit our website: www.hs2.org.uk/how-to-complain

Contact Us

Contact our HS2 Helpdesk team all day, every day of the year on:

 Freephone **08081 434 434**

 Minicom **08081 456 472**

 Email **hs2enquiries@hs2.org.uk**

Write to:

FREEPOST

HS2 Community Engagement

Website **www.hs2.org.uk**

To keep up to date with what is happening in your local area, visit: **www.hs2inyourarea.co.uk**

Please contact us if you'd like a free copy of this document in large print, Braille, audio or easy read. You can also contact us for help and information in a different language.

HS2 Ltd is committed to protecting personal information. If you wish to know more about how we use your personal information please see our Privacy Notice <https://www.gov.uk/government/publications/high-speed-two-ltd-privacy-notice>

Reference number: FUS_AWN_0075

High Speed Two (HS2) Limited, registered in England and Wales.
Registered office: Two Snowhill, Snow Hill Queensway, Birmingham B4 6GA.
Company registration number: 06791686. VAT registration number: 181 4312 30.