

Notice of construction activities, Steeple Claydon

February 2021 | www.hs2.org.uk

High Speed Two (HS2) is the new high speed railway for Britain. In response to the Covid-19 virus we have worked hard to ensure that our working practices are fully aligned with the Site Operating Procedures produced by the Construction Leadership Council and in line with Government and Public Health England advice. We will be keeping our local website www.hs2inbucksandbox.co.uk up to date with information on our works, and the measures we have in place to maintain the safety. Please be assured that only sites that can operate within the guidelines are operational. All sites will remain under constant review. We have postponed all face-to-face engagement events and meetings and have put in place a number of channels to communicate with communities, such as letters and phone calls, as well as updates and alerts from each of the local community websites. You can sign up for regular updates in your local area at www.hs2inbucksandbox.co.uk

What will we be doing?

Before the main railway construction works begin, there are sections of land that are required for ecology mitigation, drainage and associated works in relation to the East West Railway line and for the realignment and reconstruction of the new bridge on Addison Road. Prior to the main railway works, we need to undertake a number of construction activities.

Activities include:

- Temporary compound set up
- Public right of way closure
- Fencing
- Vegetation clearance
- Ecology mitigation

If you have a question about HS2 or our works, please contact our HS2 Helpdesk team on 08081 434 434 or email hs2enquiries@hs2.org.uk

Notification



Duration of works

The works will start February 2021 until summer 2021

Normal working hours:
Monday to Friday 8am – 6pm and Saturday 8am to 1pm

Our contractors may also be on site for one hour's quiet start up and shut down outside of these times.

What to expect

Some additional traffic on local roads. Some noise from equipment used for the works. Site storage and welfare vehicles. Site operated with 24hour security and temporary flood lighting

Noise from the equipment used for the works.

Temporary closure of the Public right of way

What we will do

Manage impacts, such as traffic and noise with the aim of reducing or removing them.

Notice of construction activities, Steeple Claydon

www.hs2.org.uk

Notification



Temporary compound set up

A temporary construction compound will be established to support the works taking place. To build the compound we will initially use mobile welfare facilities. Once built the compound will include temporary trackway, an office and welfare facilities alongside the storage of machinery and materials. Car parking, temporary lighting and 24-hour security will also be in place.

Public right of way closure

Public rights of way (footpaths) that cross the work area will be temporary closed for the duration of the works. This will help us keep residents safe from our machinery while the works take place. Any closures will be sign posted and more information will be on www.hs2inbucksandbox.co.uk

The public right of way is adjacent to Poors Piece Wood and is between Steeple Claydon and Rosehill Farm, reference number SCL/8/1.

The public right of way will be closed from 23 February to 22 March 2021. Signage will be located at the entrance point of the public right of way and on paths leading to the closure.

Boundary fencing

Boundary fencing work will take place in late February and is expected to finish in March 2021. Fencing will be erected along the boundaries of the land required for the construction activities.

Please refer to the enclosed map highlighting the boundary fencing.

Ecology mitigation

We will be shortly begin moving Great Crested Newts to their new habitats. The collected newts will be taken to an ecology approved mitigation site that is suitable to support the population of newts (i.e. suitable aquatic vegetation and bankside vegetation).

Notice of construction activities, Steeple Claydon

www.hs2.org.uk

Notification



Vegetation clearance

We will be continuing our programme of vegetation clearance work which began in September 2019, which will enable the future construction work for HS2.

The programme of work started in late September 2019 and will continue until April 2021. The clearance work involves part of Poors Piece Wood, Steeple Claydon alongside the existing railway line. This is to enable new drainage and fencing to be installed. More information is included on the map in this notification.

The vegetation will be removed by an arboricultural team using machinery.

Sections of vegetation will be replaced with temporary fencing, this will help us keep the site secure ahead of future construction activities.

What consents do we have to undertake this work?

Before any vegetation is cleared it will be thoroughly inspected by qualified ecologists. Any protected species found to be present will be recorded and no vegetation will be cleared until the species have left the site. The vegetation clearance will be undertaken in accordance with:

HS2 Organisational European Protected Species Great for Crested Newt Licences WML025.

HS2 Organisational European Protected Species Licence for Badger WML024.

Further details are available online.

<https://www.gov.uk/government/publications/hs2-phase-one-environmental-statement-volume-5-ecology>

The work on HS2 is guided by High-Speed Rail (London West Midlands) Act 2017.

<http://www.legislation.gov.uk/ukpga/2017/7/contents/enacted>

Notice of construction activities, Steeple Claydon

www.hs2.org.uk

Tree planting

As part of our continuing works ahead of the construction of the railway, we have been planting a large quantity of small and large trees in the local area totalling 34,000. These sites will form part of the green corridor that provides connectivity for wildlife alongside the future railway.

We have been planting small trees at 0.4 -0.6 meters in height and larger trees up to 2.5 meters in height. These larger trees are to establish new bat flight paths. We have planted a mixture of trees, which include Field Maple, Silver Birch and English oaks. The trees planted reflect the current species that exist locally.

Notification



Notice of construction activities, Steeple Claydon

Notification



www.hs2.org.uk

Map below shows areas of work

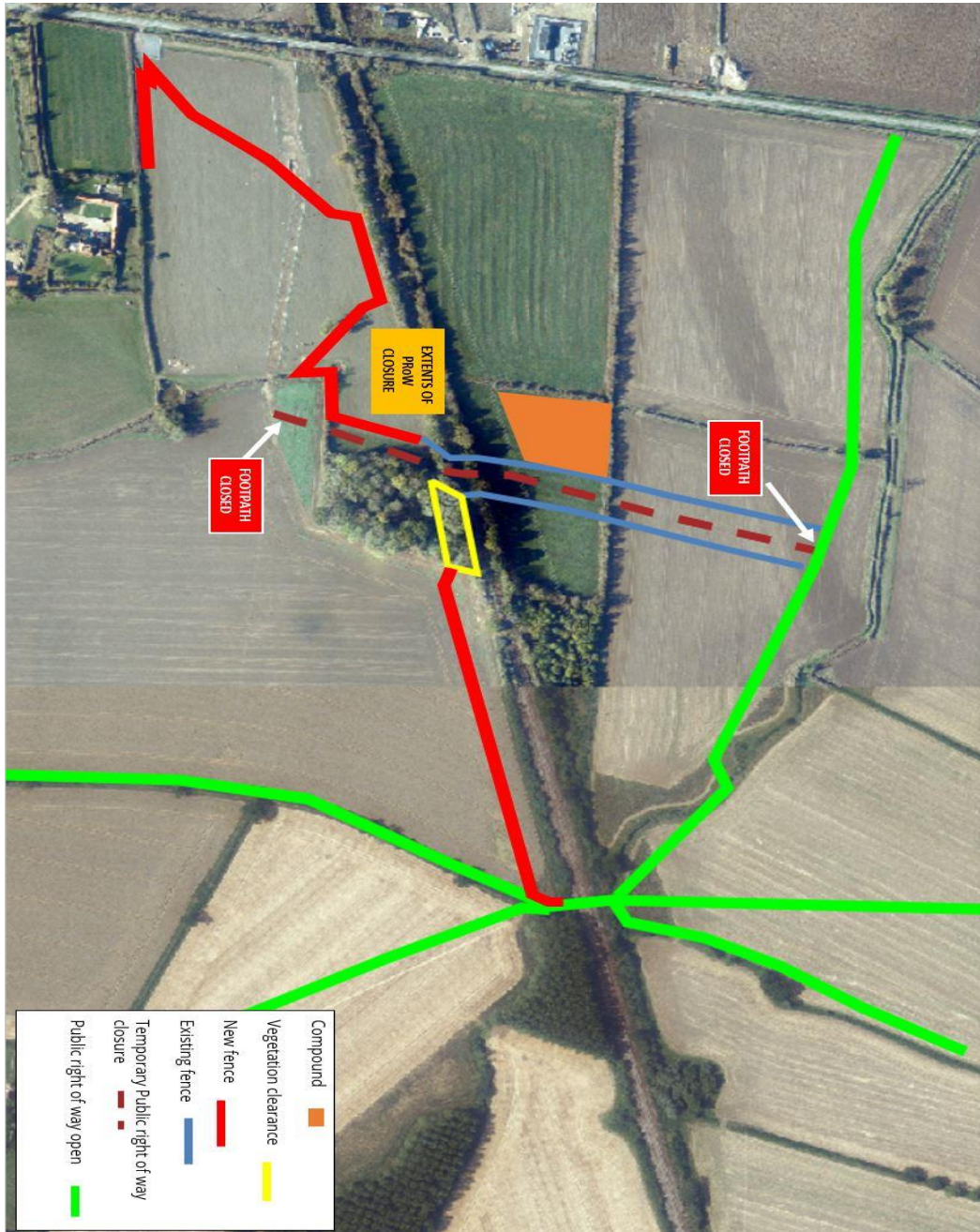

Contact our HS2 Helpdesk team on **08081 434 434**

Notice of construction activities, Steeple Claydon

Notification



www.hs2.org.uk

Map below shows the public right of way closure and available footpaths

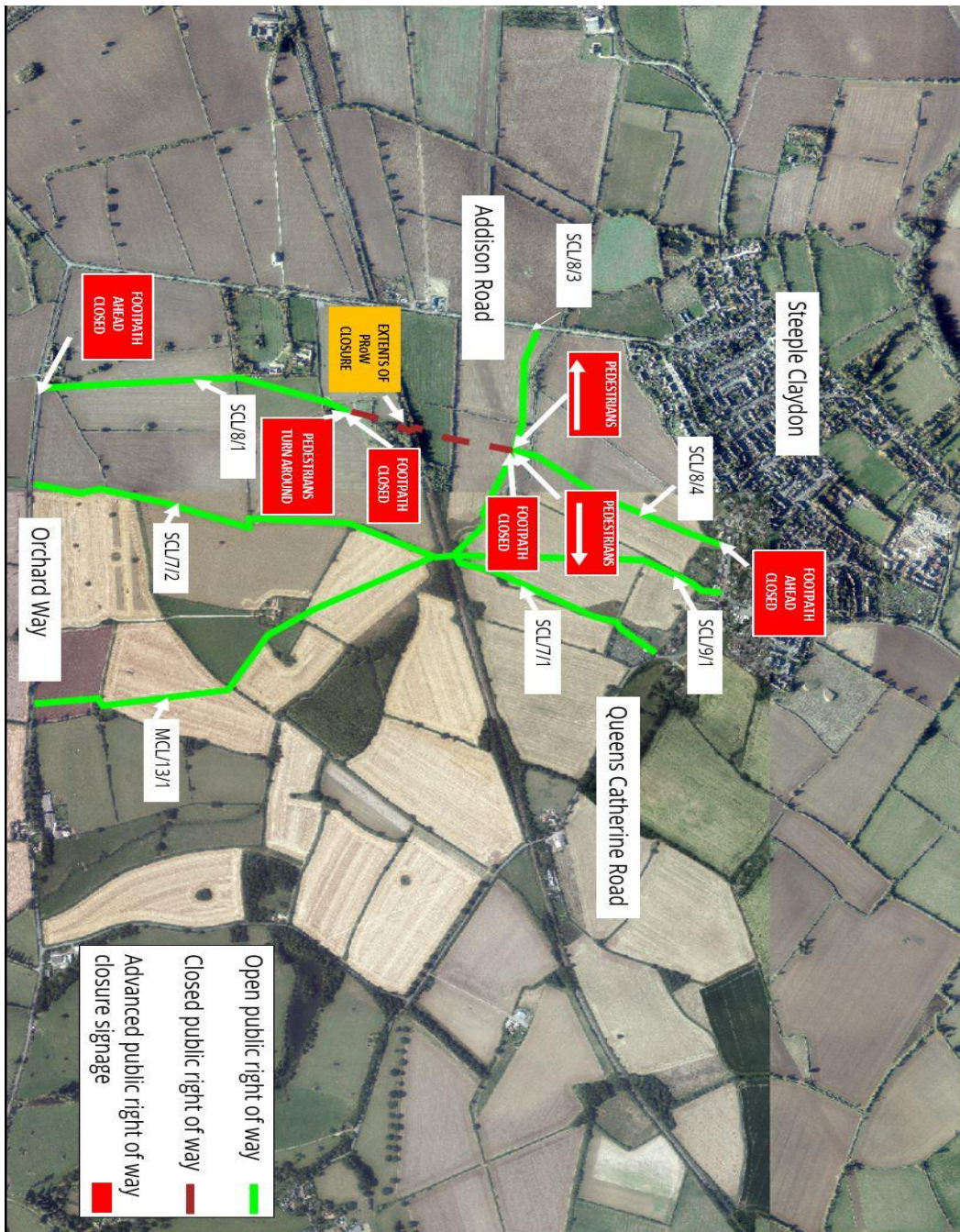

Contact our HS2 Helpdesk team on **08081 434 434**

Keeping you informed

We are committed to keeping you informed about work on HS2. This includes ensuring you know what to expect and when to expect it, as well as how we can help.

Residents' Charter and Commissioner

The Residents' Charter is our promise to communicate as clearly as we possibly can with people who live along or near the HS2 route.
www.gov.uk/government/publications/hs2-residents-charter

We also have an independent Residents' Commissioner whose job is to make sure we keep to the promises we make in the Charter and to keep it under constant review. Find reports at:
www.gov.uk/government/collections/hs2-ltd-residents-commissioner

You can contact the Commissioner at:
residentscommissioner@hs2.org.uk

Construction Commissioner

The Construction Commissioner's role is to mediate and monitor the way in which HS2 Ltd manages and responds to construction complaints. You can contact the Construction Commissioner by emailing:
complaints@hs2-cc.org.uk

Property and compensation

You can find out all about HS2 and properties along the line of route by visiting:
www.gov.uk/government/collections/hs2-property
Find out if you're eligible for compensation at:
www.gov.uk/claim-compensation-if-affected-by-hs2

Holding us to account

If you are unhappy for any reason you can make a complaint by contacting our HS2 Helpdesk team. For more details on our complaints process, please visit our website:
www.hs2.org.uk/how-to-complain

Contact Us

Contact our HS2 Helpdesk team all day, every day of the year on:

 Freephone **08081 434 434**

 Minicom **08081 456 472**

 Email **hs2enquiries@hs2.org.uk**

Write to:

FREEPOST

HS2 Community Engagement

Website **www.hs2.org.uk**

To keep up to date with what is happening in your local area, visit:
www.hs2inyourarea.co.uk

Please contact us if you'd like a free copy of this document in large print, Braille, audio or easy read. You can also contact us for help and information in a different language.

HS2 Ltd is committed to protecting personal information. If you wish to know more about how we use your personal information please see our Privacy Notice
<https://www.gov.uk/government/publications/high-speed-two-ltd-privacy-notice>

Reference number: HS2-EW-Fusion -Ph1-Ar-Ce-C2-CR-2-02/12/2021

High Speed Two (HS2) Limited, registered in England and Wales.
Registered office: Two Snowhill, Snow Hill Queensway, Birmingham B4 6GA.
Company registration number: 06791686. VAT registration number: 888 8512 56.