

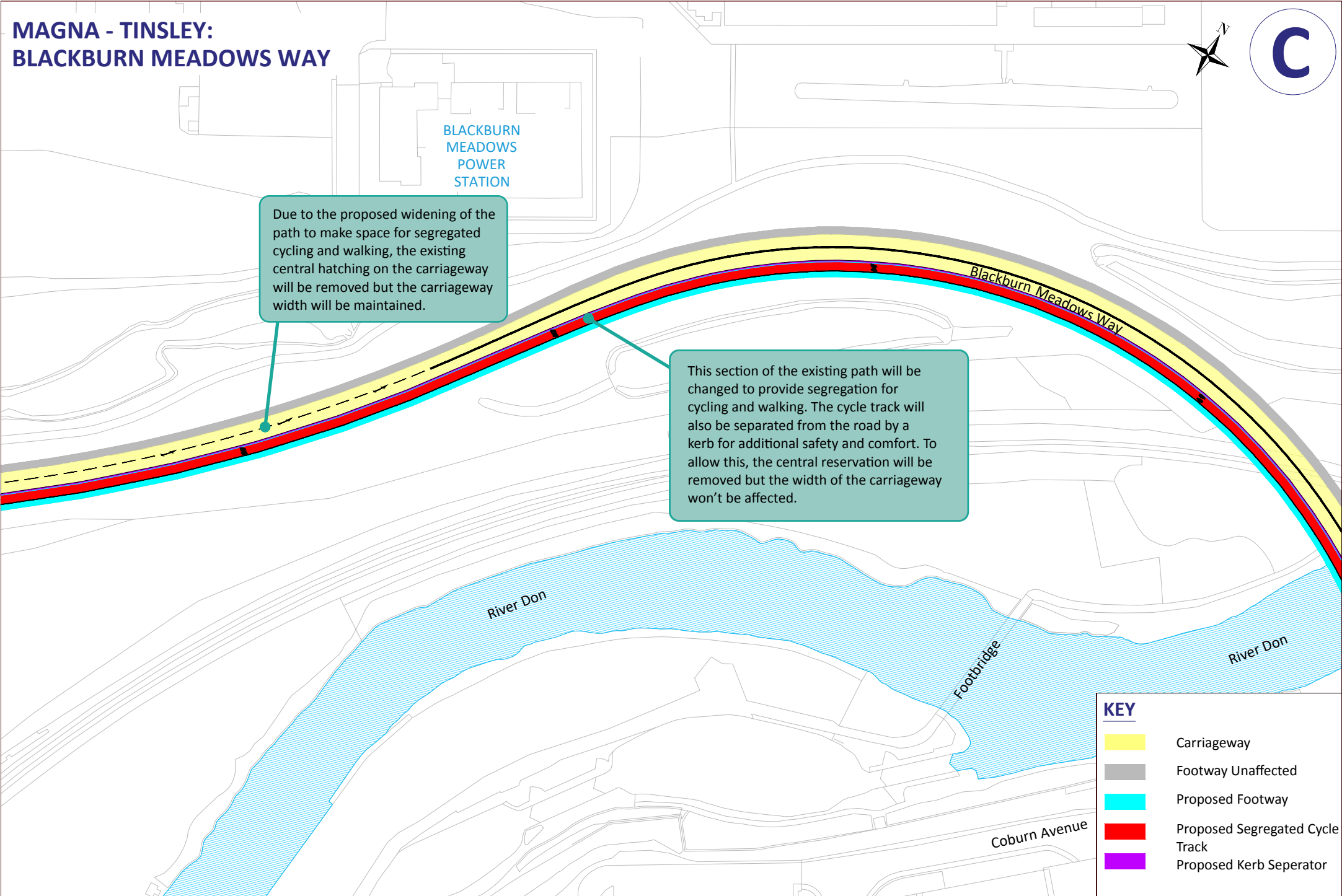

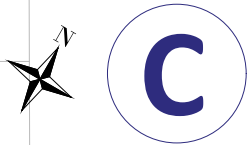



MAGNA - TINSLEY:
BLACKBURN MEADOWS WAY

BLACKBURN
MEADOWS
POWER
STATION

Due to the proposed widening of the path to make space for segregated cycling and walking, the existing central hatching on the carriageway will be removed but the carriageway width will be maintained.

This section of the existing path will be changed to provide segregation for cycling and walking. The cycle track will also be separated from the road by a kerb for additional safety and comfort. To allow this, the central reservation will be removed but the width of the carriageway won't be affected.



KEY	
	Carriageway
	Footway Unaffected
	Proposed Footway
	Proposed Segregated Cycle Track
	Proposed Kerb Seperator