

# SPLIT CORE 333mVAC SECONDARY CT's

## TYPES: SCL, SCT, ROPE

### ■ FEATURES

- Split core
- Rogowski "flexible rope" CT's
- Ideal retro-fit solution
- Compact sizes
- Safe when open circuit
- Ideal for when CT's are sited a distance from the meter (VA burden is not relevant)
- Recommended for use with our CUBE & RAIL 333mV CT input energy meters

### ■ DESCRIPTION & MODE OF OPERATION

The **SCT** and **SCL** range of split core 333mVAC secondary current transformers are designed for fast and easy installation with no need to disconnect any loads. An internal precision resistor across the secondary winding of the CT provides a safe, low voltage output of 333mVAC with minimal current. Unlike conventional 5 Amp and 1 Amp secondary CT's, where the VA burden in the secondary circuit, against the VA that is available from the CT, has to be taken into consideration. Meaning how far away the CT from the meter can be maximally sited needs to be calculated. With 333mVAC secondary CT's this is not relevant. The **SCL** range is supplied with 1 metre of flying lead cable and the **SCT** range with 2 metres.

The **ROPE** range of "flexible" Rogowski Coil current transformers are supplied only in sets of 3 in either lengths of 461mm or 610mm. The set of three are supplied with a 5VDC nominal power supply with a 100-240VAC primary to excite the CT's. These CT's also have a 333mVAC secondary and are extremely flexible making them particularly suitable when CT's are required to be fitted retrospectively in awkward situations. They are supplied with 2 metres of captive cable.

Please note, should the CT secondary cabling need to be extended 250V rated Belden Cable (or equivalent) needs to be utilised.

### ■ SPECIFICATIONS

Secondary:	0-333mVAC	Insulation:	SCL: 300Vrms
Frequency range:	50Hz - 60Hz		SCT: 600Vrms
Accuracy:	± 1%	Operating temp:	SCL: -25°C to +90°C
In max:	120%		SCT: -15°C to +60°C
Phase error:	< 2° @ 0.51n		ROPE: -20°C to +70°C

### ■ ORDERING INFORMATION & TYPES

SCL & SCT (supplied individually)					
Dimensions mm					
P/No	A	B	C	D	E
SCL8 5A	43	37	32	8	13
SCT10 30A	25	42	15	10	10
SCL16 50A	51	45	37	16	16
SCT19 50A	51	53	17	19	19
SCL16 100A	51	45	37	16	16
SCT19 150A	51	53	17	19	19
SCT32 400A	82.5	85	27	32	32
SCT51 800A	121	127	32	51	51

ROPE (supplied in sets of 3 with power supply)	
P/No	Length
ROPE 461 1000A	461mm
ROPE 461 1500A	461mm
ROPE 461 2000A	461mm
ROPE 461 3000A	461mm
ROPE 461 3500A	461mm
ROPE 610 1000A	610mm
ROPE 610 1500A	610mm
ROPE 610 2000A	610mm
ROPE 610 3000A	610mm
ROPE 610 3500A	610mm



PRODUCT  
GROUP  
Y

179

#### DIMENSIONS

##### SCL

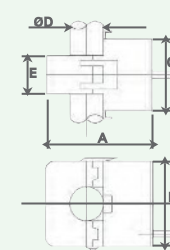

##### SCT

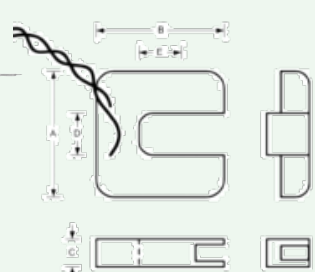

##### SCT



##### SCL

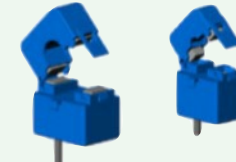

##### ROPE

